

# Shadow Boards

## Shadow Boards

Designed to simplify workplace procedures and processes, Shadow Boards help to quickly identify missing items whilst also being a key part of providing effective workplace organisation.

Suitable for a variety of equipment applications, from organising cleaning tools to Lockout and hand tools. Allowing you to implement essential 5S methodology easily into any working environment. Shadow Boards are available free standing, on castors, or wall mountable with pre-drilled holes and fixings for easy installation.

Available with or without stock and even colour coded to individual work areas or tool sets to avoid cross contamination.



## Custom

Our bespoke sign manufacturing team have extensive experience producing and installing a range of Shadow Boards nationwide.

From single units to large scale factory 5S systems, we can be depended upon to provide a fast and efficient service at a competitive RRP.

We understand that you may have specific requirements for your Shadow Boards and our team are happy to use your own artwork, or work with you to design your Shadow Boards to your exact specifications.

Contact us for more information on how we can help bring 5S Shadow Board systems to your workplace.

## The nerdy bit



- SORT**
- STREAMLINE**
- SHINE**
- STANDARDISE**
- SUSTAIN**

Enhance your **Lean Manufacturing** procedures with a custom designed 5S Shadow Board.

## Colour

All Shadow Boards and components are supplied in a range of colours, with blue, red, yellow and green available for immediate delivery. Lead times may vary on non-standard colours, please contact us for more information.



## Packaging Labels

Internationally recognised paper packaging labels, supplied in rolls of 1000.



\* 100 x 150 SAV 13868



\* 100 x 150 SAV 13871



\* 100 x 150 SAV 14789



\* 100 x 150 SAV 14210



\* 100 x 150 SAV 13872

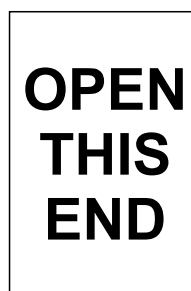

\* 100 x 150 SAV 13870

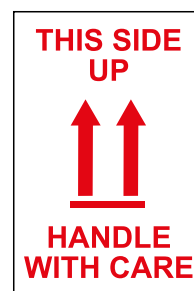

\* 100 x 150 SAV 13873

## Asbestos Labels

Printed on self adhesive Polypropylene, 500 labels per roll.



\* 25 x 50 SAV 3210



\* 25 x 50 SAV 3211



## Globally Harmonised System (GHS) Labels

Printed on self adhesive Vinyl. 50mm supplied in packs of 10, 100mm supplied individually.



\* 50 x 50 SAV 18000  
\* 100 x 100 SAV 18001



\* 50 x 50 SAV 18002  
\* 100 x 100 SAV 18003



\* 50 x 50 SAV 18004  
\* 100 x 100 SAV 18005



\* 50 x 50 SAV 18006  
\* 100 x 100 SAV 18007



\* 50 x 50 SAV 18008  
\* 100 x 100 SAV 18009



\* 50 x 50 SAV 18010  
\* 100 x 100 SAV 18011



\* 50 x 50 SAV 18012  
\* 100 x 100 SAV 18013



\* 50 x 50 SAV 18014  
\* 100 x 100 SAV 18015



\* 50 x 50 SAV 18016  
\* 100 x 100 SAV 18017



## Labels Valve Tags/Numbers and Letters

Long lasting engraved Valve Tags finished in conjunction with pipe marking identification to help comply with legislation. Circular Brass Tags with a depth of 1.6mm.

Tags which are Brass can be either natural or ink filled.



### How To Order

Choose your material, size and quantity. If you are ordering Valve Tags (engraved laminated) please also choose the colour (described below the code grid) and add this to the end of the code shown within the grid.

For example a red 27mm Engraved Laminate set from 1-25 would be **TGTR-27-1-RD**.

### Custom Tags

Engraved Laminated Custom Tags can be made into different shapes with bespoke messages in a variety of colours. Contact the sales office for further details.



Description	Code
5pcs of 100mm Tag Chain (Chrome Plated 3.2mm Ball Chain), 5 Chain Clasps	TGA-CH100
5pcs of 200mm Tag Chain (Chrome Plated 3.2mm Ball Chain), 5 Chain Clasps	TGA-CH200
5pcs of 300mm Tag Chain (Chrome Plated 3.2mm Ball Chain), 5 Chain Clasps	TGA-CH300
5pcs of 400mm Tag Chain (Chrome Plated 3.2mm Ball Chain), 5 Chain Clasps	TGA-CH400
5pcs of 500mm Tag Chain (Chrome Plated 3.2mm Ball Chain), 5 Chain Clasps	TGA-CH500
Tag Ball Chain Clasp (each)	TGA-CLASP

Sequential No.	27mm			33mm			38mm		
	Brass - Natural	Brass - Filled	Engraved Laminate (1.6mm)	Brass - Natural	Brass - Filled	Engraved Laminate (1.6mm)	Brass - Natural	Brass - Filled	Engraved Laminate (1.6mm)
1 - 25	TGBU-27-1	TGBF-27-1	TGTR-27-1	TGBU-33-1	TGBF-33-1	TGTR-33-1	TGBU-38-1	TGBF-38-1	TGTR-38-1
26 - 50	TGBU-27-26	TGBF-27-26	TGTR-27-26	TGBU-33-26	TGBF-33-26	TGTR-33-26	TGBU-38-26	TGBF-38-26	TGTR-38-26
51 - 75	TGBU-27-51	TGBF-27-51	TGTR-27-51	TGBU-33-51	TGBF-33-51	TGTR-33-51	TGBU-38-51	TGBF-38-51	TGTR-38-51
76 - 100	TGBU-27-76	TGBF-27-76	TGTR-27-76	TGBU-33-76	TGBF-33-76	TGTR-33-76	TGBU-38-76	TGBF-38-76	TGTR-38-76
101 - 125	TGBU-27-101	TGBF-27-101	TGTR-27-101	TGBU-33-101	TGBF-33-101	TGTR-33-101	TGBU-38-101	TGBF-38-101	TGTR-38-101
126 - 150	TGBU-27-126	TGBF-27-126	TGTR-27-126	TGBU-33-126	TGBF-33-126	TGTR-33-126	TGBU-38-126	TGBF-38-126	TGTR-38-126
151 - 175	TGBU-27-151	TGBF-27-151	TGTR-27-151	TGBU-33-151	TGBF-33-151	TGTR-33-151	TGBU-38-151	TGBF-38-151	TGTR-38-151
176 - 200	TGBU-27-176	TGBF-27-176	TGTR-27-176	TGBU-33-176	TGBF-33-176	TGTR-33-176	TGBU-38-176	TGBF-38-176	TGTR-38-176
201 - 225	TGBU-27-201	TGBF-27-201	TGTR-27-201	TGBU-33-201	TGBF-33-201	TGTR-33-201	TGBU-38-201	TGBF-38-201	TGTR-38-201
226 - 250	TGBU-27-226	TGBF-27-226	TGTR-27-226	TGBU-33-226	TGBF-33-226	TGTR-33-226	TGBU-38-226	TGBF-38-226	TGTR-38-226
251 - 275	TGBU-27-251	TGBF-27-251	TGTR-27-251	TGBU-33-251	TGBF-33-251	TGTR-33-251	TGBU-38-251	TGBF-38-251	TGTR-38-251
276 - 300	TGBU-27-276	TGBF-27-276	TGTR-27-276	TGBU-33-276	TGBF-33-276	TGTR-33-276	TGBU-38-276	TGBF-38-276	TGTR-38-276
301 - 325	TGBU-27-301	TGBF-27-301	TGTR-27-301	TGBU-33-301	TGBF-33-301	TGTR-33-301	TGBU-38-301	TGBF-38-301	TGTR-38-301
326 - 350	TGBU-27-326	TGBF-27-326	TGTR-27-326	TGBU-33-326	TGBF-33-326	TGTR-33-326	TGBU-38-326	TGBF-38-326	TGTR-38-326
351 - 375	TGBU-27-351	TGBF-27-351	TGTR-27-351	TGBU-33-351	TGBF-33-351	TGTR-33-351	TGBU-38-351	TGBF-38-351	TGTR-38-351
376 - 400	TGBU-27-376	TGBF-27-376	TGTR-27-376	TGBU-33-376	TGBF-33-376	TGTR-33-376	TGBU-38-376	TGBF-38-376	TGTR-38-376



# Lockout Tagout

How To Implement a Planned Loto Programme	152
What Is Lockout Tagout?	152
Why Use Lockout Tagout?	152
Energy Types	152
Current Regulations	153
The Importance Of Tagging	153
Permits To Work	153
Keying Systems and Registering	154
<b>Padlocks And Accessories</b>	
Safety Lockout Tagout Padlocks	155
Security Padlocks	156
Padlock Accessories	156
<b>Hasps</b>	
Standard Hasps	158
Dielectric Hasps	159
Sign Hasps	159
<b>Valve Lockout</b>	
Gate Valve Lockout	160
Ball Valve Lockout	161
Butterfly Valve Lockout	162
Flange Ball Valve Lockout	162
<b>Cable Lockout</b>	
Cable Lockout	163
Heavy Duty Cable Lockout	164
<b>Electrical Lockout</b>	
Mini Circuit Breaker Lockout	164
Fuse Lockout	166
Plug Lockout	167
Cylinder Lockout	168
Button Lockout	168
Pin and Sleeve Lockout	170
Electrical Panel Lockout	170
Gas Cylinder Lockout	171
Pneumatic Lockout	171
Lockboxes	172
<b>Ladder Lockout</b>	172
<b>Lockout Stations</b>	
Advanced Lockout Station	173
Build Your Own Lockout Station	175
Lockable Lockout Station	176
Tag Station	176
<b>Lockout Kits</b>	
Electrical Lockout Kits	177
Maintenance Kits	178
Large Lockout Kits	179
Lockout Bags / Boxes	180
<b>Lockout Signs</b>	181
<b>Lockout Tags</b>	182



# Lockout Tagout

## How to implement a Planned LOTO Programme?

A clearly designed LOTO programme will detail all the necessary steps to ensure equipment energy is safely isolated.

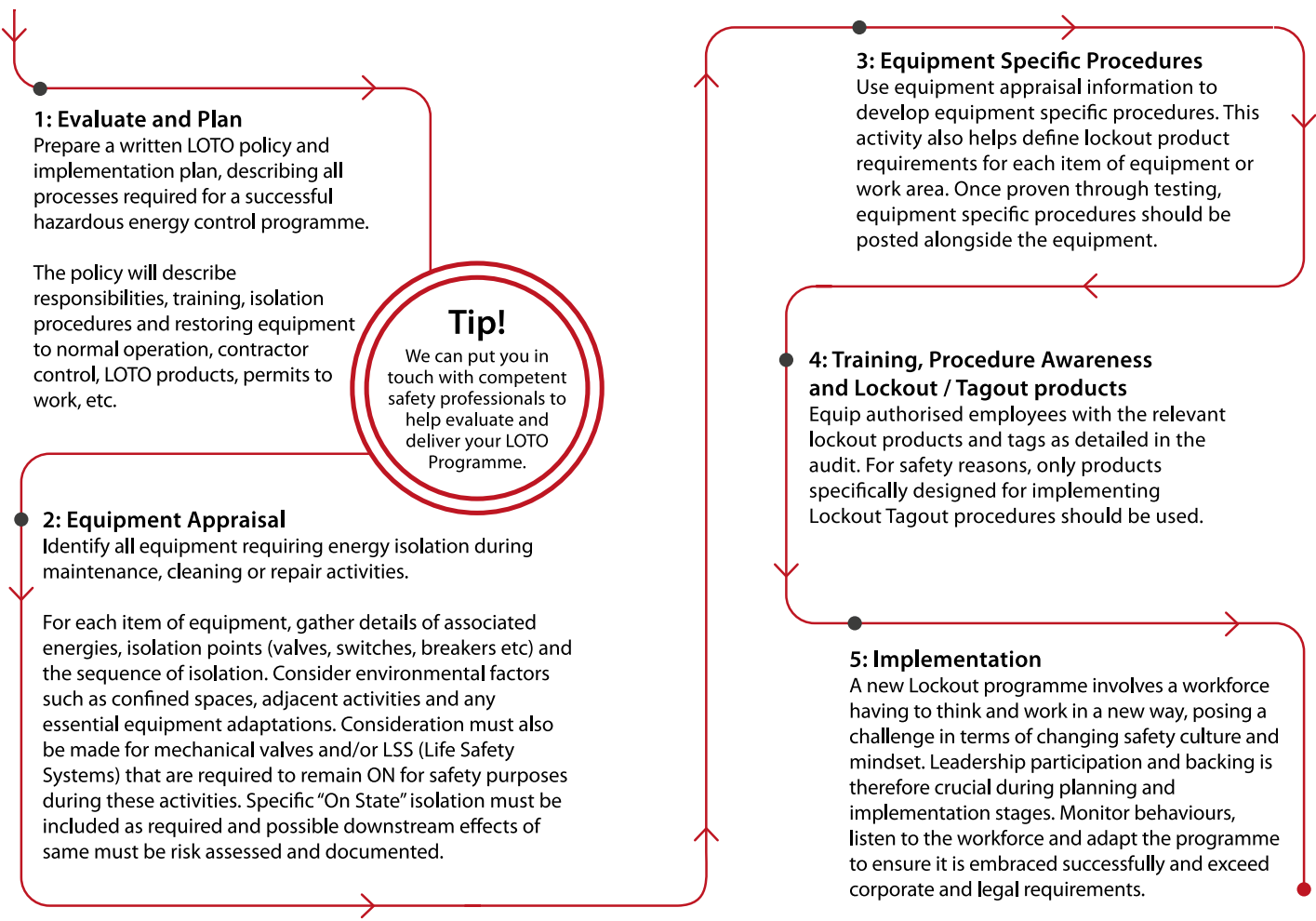

## What is Lockout Tagout? (LOTO)

**Lockout** is a physical method of isolating equipment to prevent it being re-energised or stop the release of any stored energy.



**Tagout** is a highly visible written warning attached to the locked out device highlighting that the equipment should not be used until the Lockout is removed.



## Why Lockout Tagout?

Planned Lockout Tagout Procedures are an effective way of reducing the risks involved when maintaining, cleaning or repairing equipment. Now considered a best practice procedure worldwide, correct implementation can reduce downtime and increase productivity. It helps to ensure worker safety and reduces the risk of employers exposure to liability and prosecution, as well as indirect costs such as repairs to equipment.

## Types of Energy

Dangerous energy sources can take many forms, including:

-  **Electrical Energy**  
Commonly found powering nearly all workplace equipment.
-  **Hydraulic Energy**  
Found powering forklifts, cutting equipment and pumps.
-  **Mechanical Energy**  
Can be found in all machinery with moving parts.

-  **Thermal Energy**  
In ovens or freezers (hot or cold).
-  **Pneumatic Energy**  
Most commonly found powering machinery via compressed air or gas.
-  **Potential Energy**  
Found in compressed springs or suspended weights.

## Current Regulations

UK and Ireland Health and Safety legislation is established on a framework that is not wholly prescriptive, being goal setting in nature, emphasising self-regulation, risk assessment and workforce involvement in the control of health and safety. As pioneered by US legislation and subsequent EU legislation.

**The Health and Safety at Work Act 1974** places general duties on employers to ensure, so far as reasonably practicable, the health, safety and welfare at work of their employees, including a requirement to provide and maintain safe plant and equipment.

**The Management of Health and Safety at Work Regulations 1999** require an employer to carry out a risk assessment of activities, introduce safe systems of work, coordinate activities and provide training. Isolation requirements are highlighted under specific UK and Ireland regulations.

In the UK, the following regulations govern the control of hazardous energy (CHE): **BS7671:2008(2011) "Requirements for Electrical Installations. IET Wiring Regulations." 17th Edition:**

**537.2.2.4:** Provision shall be made for securing off-load isolating devices against inadvertent or unauthorised opening.

**537.3.1.2:** Suitable means shall be provided to prevent electrical powered equipment becoming unintentionally reactivated.

**Provision and Use of Work Equipment Regulations 1998 Regulation 19 (1):** Every employer shall ensure that where appropriate work equipment is provided with suitable means to isolate it from all its sources of energy.

In Ireland, the legislation in force is: **Safety, Health and Welfare at Work Regulations 2007**. All work equipment is fitted with clearly identifiable means to isolate it from all its energy sources, and the reconnecting of the work equipment to its energy sources poses no risk to the employees concerned.

**EU CEE89/655 "Council Directive 89/655/EEC of 30 November 1989** concerning the minimum safety and health requirements for the use of work equipment by workers at work".

**Article 19:** The employer is committed to guarantee the safety and protection of employees and to take necessary measures to reduce risks to the minimum possible.

**Article 46:** The employer must ensure that all safety procedures are strictly implemented and regularly reviewed by appropriate means, employers must use all necessary tools to carry out maintenance they are responsible for and to aid them in the case of accident or emergency.

**Article 49:** When carrying out isolated maintenance, the equipment must be clearly labelled; Isolation of equipment from all possible electrical energy sources; lock-out of devices in the 'off' position; verification of isolation of all energy sources close to the maintenance area.

The USA OSHA 1910.147 "The Control of Hazardous Energy (Lockout/Tagout), Title 29 Code of Federal Regulations".

**1910.147 (c)(5)(ii)(B): Standardised.** Lockout and Tagout devices shall be standardised within the facility in at least one of the following criteria: colour; shape; or size; and additionally, in the case of Tagout devices, print and format shall be standardised.

**1910.147 (c)(5)(ii)(C):** Devices must be capable of withstanding the environment to which they are exposed for the maximum time of exposure expected.

**1910.147(c)(5)(ii)(C)(1):** Lockout devices shall be substantial enough to prevent removal without the use of excessive force or unusual techniques, such as with the use of bolt cutters or other metal cutting tools.

**1910.147(c)(5)(ii)(C)(2):** Tagout devices, including their means of attachment, shall be substantial enough to prevent inadvertent or accidental removal.

**1910.147(c)(5)(ii)(C)(2):** Lockout devices and Tagout devices shall indicate the identity of the employee applying the device(s).

# Lockout Tagout

## The Importance of Tagging

Tags are an effective way of communicating the status of equipment which is undergoing maintenance. Appropriate tags should be provided by the employer and be fit for purpose.

Tags should be:

- Durable and hardwearing.
- Resistant to moisture, oils and other contaminants.
- Easy to read and understand.
- Identify the person who installed it.
- Be attached using a method which is secure and that cannot be easily released.

Wherever possible Tags should be used alongside the appropriate Lockout device. However if there is no other physical alternative of isolation then Tags may be used alone.

In some organisations authorised personnel have their photo displayed on their tags for speed and ease of identification. This is particularly helpful in larger organisations with many employees or when using sub-contractors.

**Ask for more information on customisable Tags for your workplace.**



## Permits To Work

In many cases a Permit To Work will be required before service or maintenance will be authorised to proceed.

This written document will have its own set of instructions which need to be followed. It is good practice to have this permit to hand when performing maintenance.

Keep these documents clean and protected by using an appropriate transparent wallet or holder to store after use for reference.



**See our Permit To Work range on page 101.**



## Safety Lockout Padlocks

With a ribbed Nylon body for easy gripping and handling. Compact high security padlocks are individually keyed to differ with a 6-pin lock mechanism which will not release the key until the shackle is closed.

- 6-pin precision-machined cylinder for extra security.
- Non-conductive, non-sparking reinforced Nylon body.
- Resistant to chemicals and corrosion.
- Colour coded for easy identification with a photoluminescent label.
- Key retaining feature.
- Etched numbers/serials/initials
- Individually keyed locks for optimum security.
- Each padlock is supplied boxed with 1 key and keyring.

### 3 design variations available:

- Standard Shackle
- Long Shackle
- Nylon Shackle



Standard Shackle	Code
Red	LOK007-L
Yellow	LOK008-L
Green	LOK009-L
Blue	LOK010-L
Black	LOK011-L
Orange	LOK012-L

Long Shackle	Code
Red	LOK197-L
Yellow	LOK198-L
Green	LOK199-L
Blue	LOK200-L
Black	LOK202-L
Orange	LOK201-L

Nylon Shackle	Code
Red	LOK068
Yellow	LOK263
Green	LOK264
Blue	LOK265
Black	LOK266
Orange	LOK267

Dimensions				
Shackle height (A)	Body height (B)	Body width (C)	Shackle dia (D)	Body depth (E)
40mm	45mm	42mm	6mm	20mm
Each padlock is supplied in a box with 1 key and keyring				

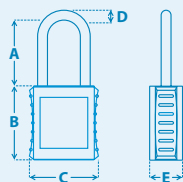

Dimensions				
Shackle height (A)	Body height (B)	Body width (C)	Shackle dia (D)	Body depth (E)
82mm	45mm	42mm	6mm	20mm
Each padlock is supplied in a box with 1 key and keyring				

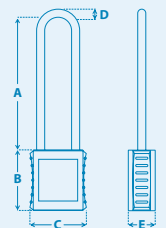

## Brass Safety Padlock

High quality Brass safety Lockout padlock with Stainless Steel shackle.

Supplied keyed to differ, they have the option to be engraved with your own reference number.



Description	Code
Brass	LOK262

Dimensions				
Shackle height (A)	Body height (B)	Body width (C)	Shackle dia (D)	Body depth (E)
55mm	40mm	39mm	6mm	15mm
Each padlock is supplied in a box with 1 key and keyring				

## Wire Padlock

A compact padlock with 3mm flexible wire shackle. This padlock is ideal for use on smaller MCB Lockouts or when a standard padlock is unsuitable.



Colour	Code
Red	LOK185

Dimensions					
Shackle height (A)	Wire length unstressed (B)	Body height (C)	Body width (D)	Shackle dia (E)	Body depth (F)
71mm	146mm	45mm	42mm	3mm	20mm
Each padlock is supplied in a box with 1 key and keyring					

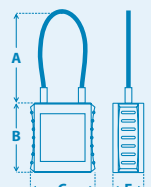



# Lockout Tagout - Padlocks and Accessories

## Security Padlocks

These padlocks are ideal for general security use and are **not recommended for use as part of a LOTO programme**.

### Blue Jacket Padlock

Regular shackle Brass padlock encapsulated in an injection moulded jacket. Supplied with warning label and 3 keys.



Size	Code
40mm	LOK070

### Laminated Padlock

Supplied with 2 keys.



Size	Code
40mm	SP150P
50mm	SP151P

### Brass 'Tri-Circle' Padlock

Standard Brass padlocks, supplied with 2 keys.



Size	Code
20mm	SP168L
25mm	SP137L
32mm	SP138L
38mm	SP139L
50mm	SP140L
63mm	SP169L

### Weather Resistant Padlock

Supplied with 2 keys.



Size	Code
40mm	SP160P

### Discus Padlock

Supplied with 2 keys.



Size	Code
70mm	SP165P

## Padlock Caddy

A simple and useful method to carry multiple padlocks. Hooks over a belt or pocket and comes complete with a retractable strap. Accommodates up to 12 padlocks.

Colour	Code
Yellow	LOK146



## Padlock Cabinet

Red powder coated Steel padlock cabinet with interior racks for the storage of padlocks.

- Stores up to 21 padlocks.
- Quality powder coated Steel.
- Wall mountable.
- Fixings included.
- 2 keys included.



Size (HxWxD)	Code
460 x 390 x 55mm	LOK059



## Padlock Station

These powder coated metal padlock stations are an ideal method for the storage and display of Lockout safety padlocks.

Description	Code
6 Padlocks (72 x 126 x 31mm)	LOK143
12 Padlocks (72 x 265 x 31mm)	LOK144
18 Padlocks (72 x 368 x 31mm)	LOK145



# Lockout Tagout - Padlock Accessories

## Aluminium Padlock Tags

Complete with collars, fixing rings and rivets. Tags can be engraved or stamped with details of keys or equipment as needed.

Description	Code
51mm (5 pack)	LOK028



## Key Covers

24mm diameter coloured key covers. Available in 2 styles and assorted colours. Supplied in packs of 50.

Description	Code
Ring Style	MI22L
Cover Style	MI132L



## Belt Clips

Self sprung Nickel plated belt clips. Pack of 12.

Code
MI122L



## Split Rings

Nickel plated split rings. Pack of 100.

Description	Code
25mm NP	MI08L
30mm NP	MI09L
38mm NP	MI10L



## Key Tags

Coloured key tags with paper inserts. Available in 2 sizes in assorted colours. Supplied in packs of 50.

Description	Code
52 x 22mm	MI13L
55 x 30mm	MI45L



## Key Cabinets

Extra strong epoxy powder coated Steel cabinet with lock. Complete with adhesive key number labels. Wall mountable. Supplied with 2 keys.

Description	Code
20 Hook (200 x 78 x 160mm)	SP227P
48 Hook (300 x 78 x 240mm)	SP228P
93 Hook (300 x 78 x 240mm)	SP229P



**Can't find what  
you're looking for?**

Contact us to see how we can help.

# Lockout Tagout - Hasps

## What are Hasps?

When more than one padlock needs to be fitted to an isolation point a hasp can be fitted to expand the number of Lockout points available. The design of a hasp ensures that all the padlocks need to be removed before the hasp can be detached.

### Standard Hasps

Manufactured from hardened powder coated Steel, our standard Lockout hasp utilises a simple scissor action to Lockout an isolation point.

The 25mm version has a double locking arrangement whilst the 38mm is a single locking system.

(25mm Hasp shown).

Size	Code
25mm	LOK048
38mm	LOK069



Manufactured from high tensile Steel sheet which has in turn been electro-plated to prevent corrosion.

The padlock fixing section is Vinyl coated to improve grip and provide greater visibility.

(25mm Hasp Shown).

Size	Code
25mm	LOK044
38mm	LOK045



Hasp Dimensions			
Description	Jaw Size (A)	# Of Holes (Padlock)	Padlock Hole dia.
Standard	25mm	6	9mm
Standard	38mm	6	9mm
Vinyl Coated	25mm	6	10mm
Vinyl Coated	38mm	6	10mm

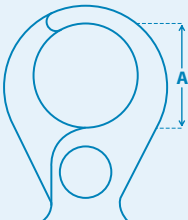

### Aluminium Hasps

Manufactured from Aluminium with injection moulded Nylon grip. The hasp jaws are rounded to provide easy fixing on smaller isolation points and Lockout devices.

Suitable for 6 padlocks with a maximum shackle diameter of up to 8mm.

(25mm Hasp shown).

Size	Code
25mm	LOK191
38mm	LOK192



### Dual Lockout Hasps

This dual scissor action hasp has a Steel body with a powder coating to prevent corrosion. The Aluminium pivot provides smooth movement.

The two different jaw sizes ensure ultimate adaptability when Lockout conditions vary.

Size	Code
See Below	LOK047



Dual Lockout Hasp Dimensions	
Inside height. (A)	31mm
Inside width. (B)	45mm
Inside height. (C)	18mm
Inside width. (D)	20mm
# Of Holes (Padlock)	6
Padlock hole dia.	11mm

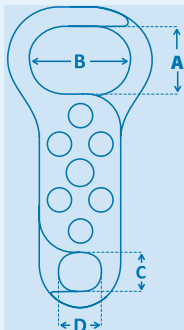

Keep your Lockout Tagout equipment easily accessible by using a Lockout Station or Lockout Kit. Find Lockout Stations on page 173 and Lockout Kits on page 177.



## Extra Large Hasps

For use in situations where multiple users need to lock out equipment. Manufactured from hardened powder coated Steel.

(24 Hole Hasp shown).

Jaw Size	# Of Holes	Code
25mm	12 Holes	LOK133
25mm	24 Holes	LOK134



## Stainless Steel Hasp

Manufactured from Stainless Steel and available in powder coated black/yellow.

Suitable for 6 padlocks with a maximum shackle diameter up to 8mm.

Description	Code
Black/Yellow	LOK129
Stainless Steel	LOK261



## Dielectric Lockout Hasp

Non-conductive reinforced Nylon hasp which opens using a pull and spring method.

With a shackle thickness of 6mm, the hasp can be locked out by up to 6 padlocks.

# Holes	Code
6	LOK127



## Die Cast Steel Hasp

Corrosion resistant Die Cast Steel Hasp with drop down opening system.

Suitable for 3 padlocks with a shackle diameter up to 8mm.

Description	Code
Steel	LOK163



## Dielectric Lockout Hasp

Our premier Dielectric Lockout Hasp utilises a unique swing lock system to securely fasten the thread.

Available in 3mm and 6mm thread sizes, each has 4 integral holes for multiple padlock use.

# Holes / Thread Size	Code
4/3mm	LOK119
4/6mm	LOK120



## Sign Hasps

This hasp combines the benefits of a standard hasp and tag simultaneously.

Manufactured from powder coated Aluminium. Supplied with spare label.

Size	Code
See dimensions below	LOK049



Similar to the hasp above, this version has a smaller head allowing application in less accessible locations. Available in 3 sizes.

# Of Holes	Code
6 Holes	LOK130
8 Holes	LOK131
10 Holes	LOK132



## Dielectric Lockout Hasp

Manufactured from reinforced Nylon, these hasps are tough, flexible and have the added benefit of being completely non-conductive.

Accepts padlocks with a shackle diameter up to 9mm.

3 different size options available.

# Holes / Thread Size	Code
3/3mm	LOK053
3/6mm	LOK054
6/6mm	LOK046



Sign Hasp Dimensions			
Inside height. (A)	Inside width. (B)	# Of holes (Padlock)	Padlock Hole dia.
43mm	81mm	10	8mm

Sign Hasp Dimensions	
Inside height. (A)	
25mm	

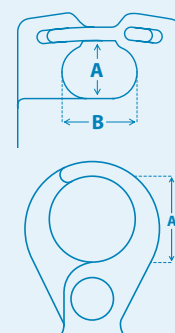



# Lockout Tagout - Valve Lockout

## What is a Gate Valve Lockout?

A simple solution for isolating gate valves. Once the valve is in the appropriate position, simply slip the Lockout over the top of the handle, rotating freely around the valve stem and thus preventing access and movement of the valve.

The different sizes cover the most commonly used valve diameters. Where a Gate Valve Lockout cannot be used due to fitting or other restraints, consider using a Cable Lockout system to isolate the valve (see **page 163** for our full range of Cable Lockouts).

- Resistant to cracking and abrasion.
- Dielectric properties.
- Rotates freely around valve handles.
- Resistant to extreme temperatures.
- Suitable for hasps and padlocks.
- Available in various sizes.



## Using a Gate Valve Lockout

Slip the Lockout over the top of the valve handle. Once in position the cover will rotate freely thereby preventing the valve from turning.

### Directions For Use:



#### Step 1

Ensure the valve is in the required locked off position (on/off). Select the appropriate sized Lockout for the gate valve.



#### Step 2

Place the Lockout device over the valve wheel and close, ensuring it can rotate freely around the wheel.



#### Step 1b (Optional)

Optional clip out center. Please specify if you would like the Lockout with pop out center when placing your order. (For use on valves with a rising stem).



#### Step 3

Secure Lockout with a safety padlock and attach a tag to communicate your chosen safety message. Use a hasp if more padlocks are required.

## Gate Valve Lockout

Comprising of 2 flattened half moons with a hollow centre. Hinged at one side, they are placed over the valve and then closed, ensuring that the valve wheel is tamper-proof. Use a hasp if more than one padlock is required to Lockout the device.

(Millimetres)	(Inches)	Code
25 - 63.5mm	1" - 2 1/2"	LOK001
63.5 - 127mm	2 1/2" - 5"	LOK002
127 - 165mm	5" - 6 1/2"	LOK003
165 - 254mm	6 1/2" - 10"	LOK004
254 - 355mm	10" - 14"	LOK005

**Please ask if you require the Gate Valve Lockout with a clip out center.**



Dimesions	(A)	(B)	(C)	(D)	(E)
25 - 63.5mm	70	32	76	38	N/A
63.5 - 127mm	130	34	140	44	33
127 - 165mm	170	41	177	50	53
165 - 254mm	257	50	267	63	70
254 - 355mm	355	63	368	74	74
(A) Inside diameter (B) Inside depth (C) Outside diameter	(D) Outside depth (E) Inner hole diameter				

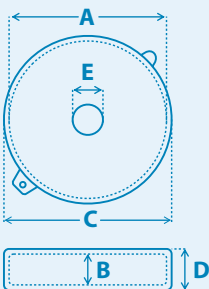

# Lockout Tagout - Valve Lockout

## Extra Large Gate Valve Lockout

Our largest sized Gate Valve Lockout is suitable for valve handles with a diameter of 330mm up to 450mm. It has an integral clip out centre and a built in facility to use up to 4 padlocks without the need for a hasp.

When not in use one side of the Lockout fits within the other for transportation and storage.

Size	(Inches)	Code
330 - 450mm	13" - 18"	LOK204



Dimensions	(A)	(B)	(C)	(D)	(E)
330 - 450mm	470	75	475	90	90
(A) Inside diameter (B) Inside depth (C) Outside diameter	(D) Outside depth (E) Inner hole diameter All sizes in millimeters				

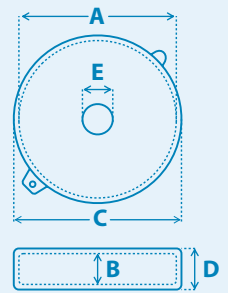

## Adjustable Gate Valve Lockout

2 separate pieces which slide over the valve and lock together. Fits valve hand wheels between 25.5mm and 165mm in diameter.

Size	(Inches)	Code
25.5 - 165mm	1" - 6 1/2"	LOK006



## What is a Ball Valve Lockout?

This Lockout device is placed over the top of the ball valve to prevent the valve handle from being turned.

## Using Ball Valve Lockouts

Once in the correct isolated position, the handle of the valve is trapped within the body of the Lockout, preventing the handle from being operated.



## Directions For Use:

### Step 1

Turn the valve handle to the correct position - either on or off.



### Step 2

Lockout the device by placing the main body over the top of the valve handle. Ensure the valve handle sits inside channel.



### Step 3

Move slider section down the shaft of the Lockout until tight against the valve body.



### Step 4

Insert a padlock or hasp through the most appropriate hole which keeps the slider secure.



**Please note:** Holes on the slider section have a staggered repeat which ensures that at least one hole will be tight when placed against the valve. If more than one padlock is required then a hasp should be used.

# Lockout Tagout - Valve Lockout

## Ball Valve Lockout

This Lockout device is placed over the top of the ball valve to prevent the valve handle from being turned. 3 sizes available.

Size	Code
9.5 - 31mm	LOK023
32 - 63mm	LOK024
50 - 203mm	LOK025



## Butterfly Valve Lockout

When slid into position the wedge on the slider section prevents the compression handle being squeezed, preventing operation of the valve.

Working in a similar way to the standard Ball Valve Lockouts, the wedge on the slider section sits between the compression handle and lever, preventing operation.

Size	Code
8 - 45mm	LOK018



## Flange Ball Valve Lockout

Once the flange ball valve is in the desired position and the handle removed, this Lockout device fits over the top of the stem ring.

The two sections of the device slide together over the top of the stem, ensuring it is suitable for various sizes of valves. Hole size: 46 x 38mm

Size	Code
150 x 220 x 70mm	LOK186



### Directions For Use:

#### Step 1



#### Step 2



#### Step 3





# Lockout Tagout - Cable Lockout

## What is a Cable Lockout?

Cable Lockouts are ideal when there is a need to Lockout multiple energy sources with one device or when the design or placement of the energy source prevents other types of Lockout being used.

## Using Cable Lockouts

Use the flexible cable to tie off the energy source and then secure using the grip handle. The handle traps the cable and prevents it from becoming loose. Multiple padlocks can be used on the handle if required.

## Multi-Purpose Cable Lockout

This Cable Lockout has been ergonomically designed to fit the hand, making placement and use fast and simple.

Route the cable where necessary to Lockout the device then feed the cable down the centre of the open Lockout. When the cable is tight and the source is locked out, squeeze the handle closed and apply padlock.

Available in Vinyl coated Steel and Nylon cable versions.

Cable type	Code
2.5m Steel Core (Blue)	LOK013
2.5m Nylon Core (Yellow)	LOK014



## Retractable Cable Lockout

This unique Cable Lockout has an integral rewinding mechanism, pulling the cable taut once it has been routed to Lockout the equipment. It can house up to 2 padlocks of a maximum diameter of 7mm.

Dimensions: 110 x 110 x 40mm  
Cable diameter: 2mm

Cable Length	Code
1.8m	LOK217



## Directions For Use:

### Step 1

Pull out the cable and route it through the equipment to Lockout the device. Feed the cable back to the Cable Lockout and place the loop around the hook.



### Step 2

Push the winding button and the cable will automatically retract, pulling it tight.



### Step 3:

Push in the black grip handle to lock the cable in place. Affix up to 2 padlocks on the unit (more can be fitted using a hasp) and Tagout as appropriate.



**Note:** To remove, push in the black grip handle to release the cable.



# Lockout Tagout - Electrical Lockout

## Heavy Duty Cable Lockout

A heavy duty Cable Lockout that can be applied to large valves. Suitable for the most extreme weather conditions including offshore installations.

Due to its metal construction and Stainless Steel nut this Lockout provides reliable and corrosion resistant use. (Please note that the Stainless Steel cable is supplied separately).

Description	Code
Lockout Only	LOK135
2M Stainless Steel Cable	LOK136
5M Stainless Steel Cable	LOK137



## Universal Mini Circuit Breaker Lockout

This universal MCB Lockout has been designed to fit almost any size of MCB, regardless of size or the position of the holes on the breaker.

Simply turn off the breaker and place the Lockout over the switch. Use the thumbscrew to tighten the internal grub screw onto the switch, locking the unit into place.

The thumbscrew will then fold down on its integral hinge, allowing a padlock to be fitted preventing access to the thumbscrew.

Clamp Size	Code
10 x 20mm	LOK043

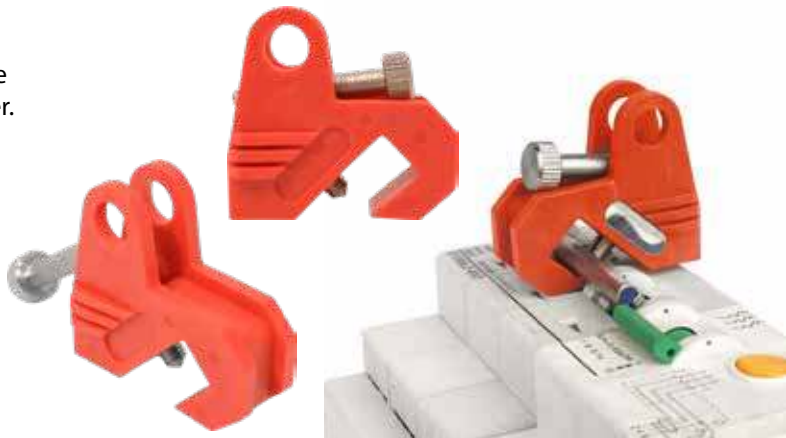

## Universal Mini MCB Lockout

Our smallest MCB toggle is easy to use - simply place over the breaker and tighten the internal grub screw.

Once secure fit a padlock or appropriate hasp through the hole to prevent unauthorised removal. Maximum clamping size  $\leq 6\text{mm}$ .

Clamp Size	Code
$\leq 6\text{mm}$	LOK161



## Universal 'Tool Free' MCB

This MCB lockout device utilises a thumb-screw for easy 'no tools' installation and is suitable for use on virtually all ISO/ DIN circuit breakers. It can be fitted vertically or horizontally, and is small enough to be used side by side on adjacent breakers.

Simply lift up the cover and fit the unit onto the MCB toggle when in the OFF position, screw down the thumbscrew tight and close the cover, locking out the unit with a padlock. The device also has 2 locking options providing flexibility when applying a padlock either vertically or horizontally.



Clamp Size	Code
8 x 15mm	LOK277

## Looking for Electrical Button Lockouts?

Find them on page 169.

## Mini Circuit Breakers

Our range of miniature circuit breaker (MCB) lockouts have been designed to fit most modern single and multiple pole miniature circuit breakers. The lockout prevents the circuit breaker toggle from being turned on, use appropriate padlock to prevent unauthorised removal.

Due to the size of these MCB lockouts, should you need to use a hasp to increase the number of padlocks we recommend the di-electric hasp LOK053 or wire padlock LOK185. All of the following MCB lockouts can be locked out using a single safety padlock with a maximum shackle diameter of 7mm.

Fitting	Code
'Pin Out'	LOK205
'Pin In'	LOK206
'Pin Out Wide'	LOK208
Tie Bar Lockout	LOK207



### 'Pin Out' (LOK205)

Designed to fit most popular breakers up to 60 Amp.

### 'Pin In' (LOK206)

Designed to fit most popular breakers up to 60 Amp.

### 'Pin Out Wide' (LOK208)

This MCB has an extra wide body to fit breakers greater than 60 Amp.

### Tie Bar Lockout (LOK207)

Adjustable thumb wheel operation fits larger or multi-pole circuit breakers connected with a cross bar. Requires no holes in the breaker to fit.



# Lockout Tagout - Electrical Lockout

## Universal MCB Lockouts

A universal Lockout which is fitted using an internal grub screw or thumb turn screw. Suitable for single or multi-pole breaker.

Width	Code
10mm	LOK121
10mm	LOK122
22mm	LOK141



LOK121



LOK122



LOK141

## Large MCB Lockout

Fitted using an internal grub screw, this universal Lockout is suitable for larger circuit breakers and can be fitted to toggles  $\leq 35\text{mm}$  in depth and  $40\text{mm}$  wide.

Clamp Size	Code
$\leq 35\text{mm} \times 40\text{mm}$	LOK142



## Universal MCB Lockout

Fitted using an internal grub screw. This version is suitable for most Siemens style branded circuit breakers. Maximum clamping size  $\leq 5\text{mm}$ .

Clamp Size	Code
$6 \times 4\text{mm}$	LOK138



## 3 Phase Circuit Breakers Lockout

Designed for 3 phase breakers, this large Lockout fits over the switch and then the screw is tightened using the clock style section. When tight the clock section is locked to the main body through a sliding section fitted to the main body.

Will accept 3 separate padlocks with a shackle diameter up to  $8\text{mm}$ .

Clamp Size	Code
$77 \times 25\text{mm}$	LOK055



## Fuse Lockout

Fitted using an internal grub screw, the universal Fuse Lockout is suitable for use on fuse holders from  $20\text{Amp}$  to  $400\text{Amp}$ , manufactured from Nylon. Maximum clamping size  $\leq 5\text{mm}$ .

Clamp Size	Code
$5 \times 9\text{mm}$	LOK140



## Medium Circuit Breaker Lockout

For use on medium sized circuit breakers, turn the circuit breaker into the off position and place the Lockout over the toggle switch. Tighten the screw thread until tight to the toggle with the integral pedal sitting into the housing of the breaker to prevent removal.

Maximum toggle width:  $20\text{mm}$

Description	Code
With Pedal	LOK209

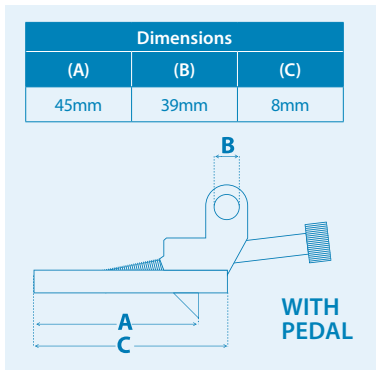



# Lockout Tagout - Electrical Lockout

## Multi-Function Circuit Breaker Lockout

Fits on top of a variety of push button breakers. This unit traps the button to help prevent it being pushed. Designed primarily as a visual deterrent to prevent accidental reactivation of the circuit.

Maximum toggle width / height: 20mm

Description	Code
Without Pedal	LOK210



Dimensions		
(D)	(E)	(F)
19mm	7mm	29mm

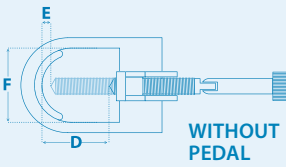

WITHOUT PEDAL

## Large Circuit Breaker Lockout

Designed to fit on the largest circuit breakers. Turn the circuit breaker into the off position and place the Lockout over the toggle switch. Tighten the screw thread until tight to the toggle with the integral pedal sitting into the housing of the breaker to prevent removal.

This unit is available in 2 sizes to allow for fitting to various sizes of breaker. Maximum toggle height: 20mm - 30mm

Description	Code
Small (20mm)	LOK211
Large (30mm)	LOK212



Dimensions	
(A)	70mm
(B)	42mm
(C)	5mm
(D)	24mm
(E)	30mm
(F)	8mm
(G)	25mm

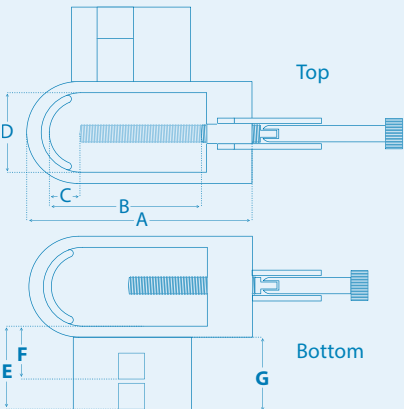

Top

Bottom



## Plug Lockout

Manufactured from industrial reinforced Polystyrene, the unit has been developed to completely enclose electrical plugs to prevent a machine being energized.

**Small Unit:** Suitable for a variety of electrical connections up to 40mm diameter. Accepts up to 4 safety padlocks.

**Large Unit:** Suitable for standard and larger electrical plugs, including 3 phase connectors. It also has 4 holes of 3 different sizes suitable for pneumatic male air hose connectors. Accepts up to 4 safety padlocks.

Size	Code
Small (4 Holes)	LOK029
Large (4 Holes)	LOK030



Dimensions	Small	Large
Inside height. (A)	43mm	85mm
Inside width. (B)	81mm	155mm
Inside depth. (C)	43mm	85mm
Padlock Hole dia.	8mm	8mm
Electrical access Holes (dia.)	1 @ 13mm	1 @ 11mm 1 @ 19mm
Pneumatic access Holes (dia.)	-	1 @ 7.5mm 2 @ 9.5mm 1 @ 12mm

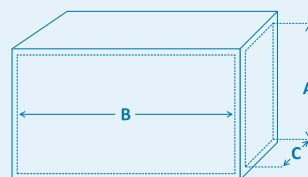

## Electrical Plug Lockout

Manufactured from Polypropylene, the hexagon design opens up in two halves and is suitable for a variety of industrial plugs. The small can accommodate 2 padlocks whereas the large can accommodate 4. Accepts padlocks with a shackle diameter of 7mm or less.

Size (See dimensions below)	Code
Small (2 Holes)	LOK188
Large (4 Holes)	LOK190



Dimensions		
Size	Small	Large
(A) height	51mm	83mm
(B) width	89mm	178mm
(C) depth	51mm	83mm
(D) circle dia	13mm	25mm
# of holes	2	4
Inner height	42mm	74mm
Inner length	80mm	165mm

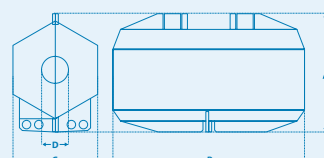



# Lockout Tagout - Electrical Lockout

## Electrical Cylinder Lockout

This large Electrical Plug Lockout has 2 interlocking cover plates allowing plugs with various sizes of cable to be inserted. Interior size of 84mm dia. x 150mm and will accept cable widths up to 34mm dia.

- 1. Shown with both plates open allowing insertion of the plug.
- 2. Shown with cover plate A in place giving a cable access hole of 34mm.
- 3. Shown with cover plate B in place giving a cable access hole of 16mm.
- 4. Shown with both plates in place giving a cable access hole of 10 x 15mm.

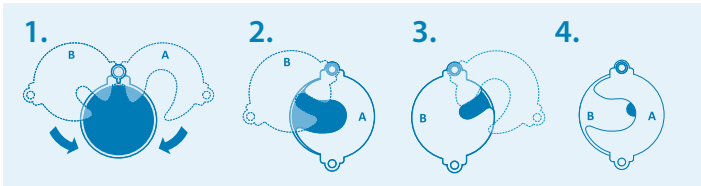

Size	Code
97mm dia x 160mm	LOK058

## Switch and Socket Cover

Ensure vital equipment cannot be accessed by locking off the socket at the wall outlet. This Lockout is suitable for standard UK single sockets, and can be used for switches, power sockets, network points etc.

To fit, isolate the power to the outlet, loosen the screws and place the cover behind the faceplate. Re-tighten the screws pulling the cover into place. To use cover with plug sockets, turn the cover 90°. Up to two padlocks can be fitted, if more are needed consider using a suitable hasp.

**Note:** Cable gaps are located at the side and may not be suitable for thicker/rigid cables.



Size	Code
Single Gang	LOK215

## Button Lockout

Manufactured from Glass Resin Polycarbonate, these Lockouts permanently fit over the stem of the button and adhere to the back panel. Available in two sizes, they can be locked out using our standard padlocks or a suitable hasp.



Hole diameter	Code
22mm	LOK193
30mm	LOK194

## Push Button Lockout

Designed to encapsulate standard push buttons, this Lockout comes with a locking cap to ensure the enclosure cannot be removed without fully removing the padlock.

**Small:** 75mm diameter by 40mm high, with a 30mm hole to sit around the foot of the button.

**Large:** 70mm diameter by 80mm high, with a 30mm hole to sit around the foot of the button.

Size	Code
Small	LOK125
Large	LOK126



Dimensions		
Size	22mm	30mm
(A) Dia	46mm	46mm
(B) Inner circle dia	22mm	30mm
(C) height	31mm	31mm
(D) Inner width	44mm	44mm
# Of holes	1	1

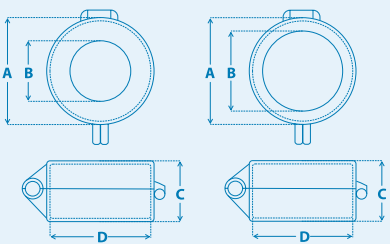

# Lockout Tagout - Electrical Lockout

## Button Lockout

Manufactured from Glass Resin Polycarbonate, this Lockout unit fits around the stem of a button which can then be locked out using a standard padlock.

This unit can be fixed either permanently or temporarily. To fit permanently, use the circular section around the stem of the button and shut the cover in place when needed.

To fit temporarily, use the semi-circular section to sit round the stem prior to fitting the cover and remove when finished.

Size	Code
See Below	LOK195

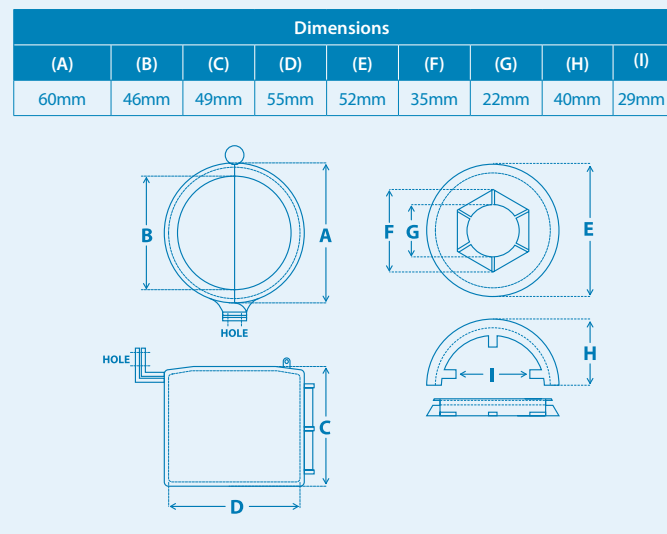

## Button Lockout

This Lockout unit fits around the stem of a button which can then be locked out using up to two standard padlocks.

Manufactured from Glass Resin Polycarbonate.

Hole diameter of 22 - 30mm.

Size	Code
See Below	LOK187

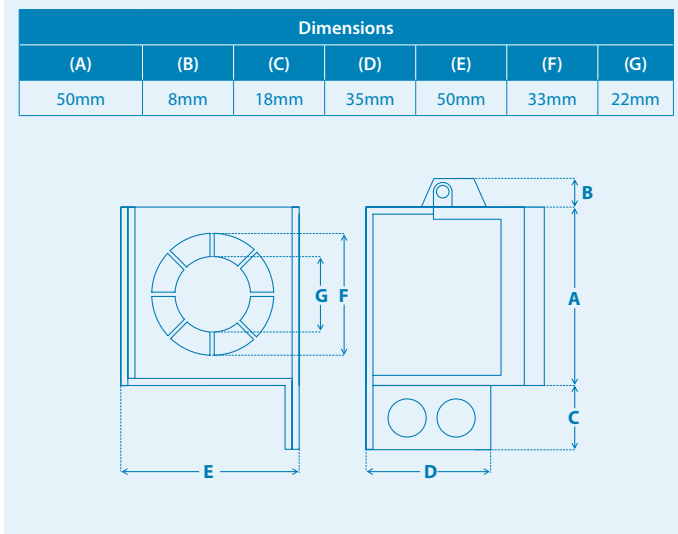
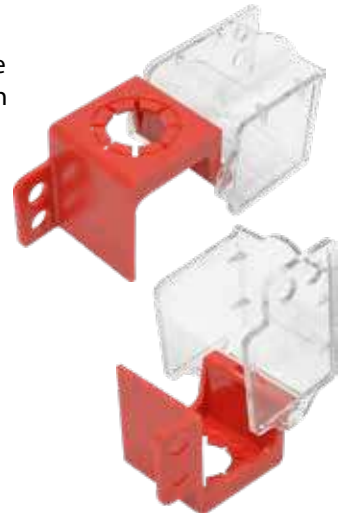

## Electrical Labels

Our Electrical Safety Labels are durable and convenient. They are available in a range of sizes, packs and roll quantities.

**Find the full range of Electrical Labels on page 138.**



# Lockout Tagout - Electrical Lockout

## Pin and Sleeve Plug Lockout

This Lockout fits onto the rim of the male socket, locking in place and preventing insertion into the socket.

To use, open the Lockout and slip it over the top of the locating tab on the rim of the plug. Close the Lockout and secure it with a padlock and affix a tag to display the relevant safety information.



Fits Plug Size	Code
16A - 125A	LOK168

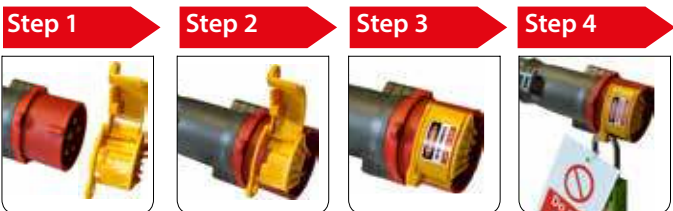

## 3 Pin Plug Lockout

Ideal for use with power supplies of computers and similar devices. This Lockout inserts into the back of the power supply and the circular paddle is then rotated to lock the device in position. A padlock can then be used to prevent the device being removed.



Size	Code
33 x 130 x 29mm	LOK123

## Electrical Panel Lockout

Lockout Electrical Panel Buttons and Switches with no inbuilt Lockout provision.

- 4 different designs.
- 2-stage operation.
- Push / mushroom panel buttons.
- Square units - switch levers.
- Adhesive backing.

Attach the base plate directly onto the electrical panel. Isolate the unit by placing the housing unit over the top preventing access to the switch.



Size	Code
Small Round	LOK064
Large Round	LOK065
Large Square 45°	LOK066
Large Square 90°	LOK067

Dimensions				
Description	Inside size HxW (A)	Plate size HxW (B)	Cover size HxW (C)	No. Of Padlock holes
LOK064 - Small Round	35mm dia.	50 x 50mm	45mm dia.	1
LOK065 - Large Round	45mm dia.	60 x 60mm	55mm dia.	1
LOK066 - Square 45 Degree	65 x 74mm	95 x 95mm	85 x 85mm	2
LOK067 - Square 90 Degree	65 x 74mm	95 x 95mm	85 x 85mm	2

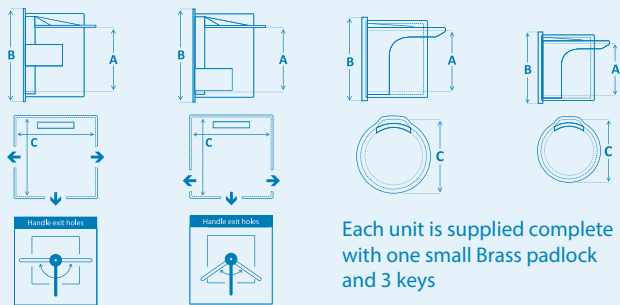

Each unit is supplied complete with one small Brass padlock and 3 keys

## Photoluminescent Signs

The visibility of standard emergency signs can often be impaired by poor lighting, smoke or even a lack of power.

We use P.S.P.A Class B material, tested to DIN 67510 Part 1-4. Once fully charged will glow for 10+ hours.



Find our Photoluminescent Signs on page 12.





# Lockout Tagout - Electrical Lockout

## Gas Cylinder Lockout

Used to prevent access to the main cylinder valve, the unit encloses the valve head and is locked in place with 2 interlocking plates.

Installs in seconds and provides quick and easy identification of a full cylinder with the security of a padlock to lock the device in place to prevent unauthorised use.

Each Lockout is supplied with 2 extra labels which can be fixed onto the Lockout to depict if the cylinder currently being locked out is full or empty.

Interior size of 84mm dia. x 150mm, accepts neck rings up to 34mm dia.

Size	Code
97mm dia x 160mm	LOK056

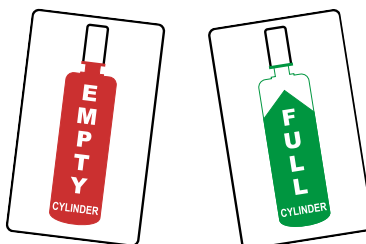

## Pneumatic Lockout

Manufactured from solid Stainless Steel this Pneumatic Lockout is strong, durable, resistant to corrosion and fits virtually all pneumatic fittings used in manufacturing facilities.

To use, place the pneumatic male fitting between the appropriate sized hole and close with a scissor action, this then prevents the hose from being used.

Once the Lockout is in its closed position it can be locked using up to 2 safety padlocks.

Code
LOK063

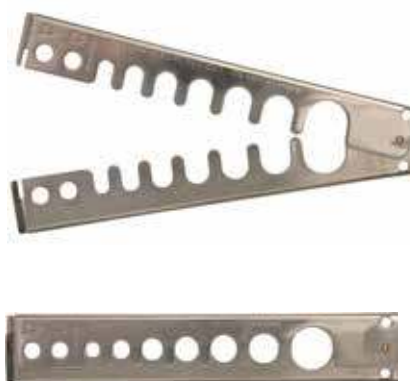

## Plug/Pneumatic Lockout

Manufactured from sturdy Polystyrene, the unit has been developed to completely enclose electrical plugs to prevent a machine being energized. The plug sits inside the unit with the cable being fed through an access hole.

The small unit is suitable for a variety of electrical connections up to 40mm diameter, with a locking mechanism taking up to 4 safety padlocks.

The large unit is suitable for standard and larger electrical plugs, including 3 phase connectors. It also has 4 holes of 3 different sizes suitable for pneumatic male air hose connectors. The unit has a locking mechanism suitable for up to 4 safety padlocks.

Size	Code
Small (4 Holes)	LOK029
Large (4 Holes)	LOK030



Dimensions	Small	Large
Inside Height. (A)	43mm	85mm
Inside Width. (B)	81mm	155mm
Inside Depth. (C)	43mm	85mm
Padlock Hole dia.	8mm	8mm
Electrical access Holes (dia.)	1 @ 13mm	1 @ 11mm 1 @ 19mm
Pneumatic access Holes (dia.)	-	1 @ 7.5mm 2 @ 9.5mm 1 @ 12mm

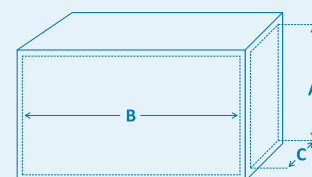



# Lockout Tagout - Lockboxes and Ladder Lockout

## What are Lockboxes?

Provision of a safe location to store keys and other activation devices during maintenance or repair.

## When to use Lockboxes?

Once equipment has been isolated and made safe, any keys or other activating equipment can be stored safely in a Lockbox to prevent accidental re-energisation. Multiple padlocks can be affixed to the Lockbox which all must be removed before gaining access to the contents.

### Lockbox

Red powder coated Steel Lockbox for storage of keys or other machine activation devices.

Once a machine has been isolated and made safe, its keys are placed in the Lockbox; each authorised person working on the machine then applies their own padlock to the Lockbox, ensuring the keys cannot be accessed until every authorised user is satisfied the machine is safe.

- 13 padlock fixing holes.
- Carry handle on top.

Size (HxWxD)	Code
155 x 255 x 100mm	LOK015



### Compact Lockbox

A compact version of the Lockbox, suitable for up to 7 padlocks.

Size (HxWxD)	Code
155 x 115 x 110mm	LOK150



### Ladder Lockout

Manufactured from flexible woven PVC, this device is placed over the rungs of a ladder or the steps of other climbing apparatus to prevent its use. The integral eyelet allows it to be locked out with a suitable padlock and tag.



Size	Code
See below	LOK245

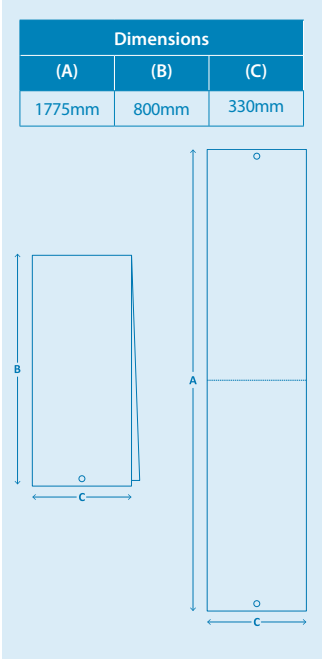

### Wall Mount Lockbox

A compact Lockbox suitable for wall fixing or use as a mobile unit. Suitable for up to 15 padlocks.

Size (HxWxD)	Code
258 x 160 x 85mm	LOK169



## What are Lockout Stations?

Lockout Stations provide a storage solution for your Lockout equipment when not in use.

## When to use Lockout Stations

A Lockout Station should be located wherever it is deemed most appropriate for its desired purpose. This could be next to the equipment to be locked out, in a maintenance department or a central location. The absence of any equipment is immediately apparent and the missing items can be traced or replenished.

### Advanced Lockout Station (Small)

Multiple padlock positions, each position can hold 2 padlocks, a hasp, several tags and/or Cable Ties. Supplied with cover that enables the station to be locked out. Engineered from Plastic PC.

Board dimensions (HxWxD): 406 x 315 x 65mm

Description	Quantity	Code
Advanced Station Lock Board (Small)	1	LOK219
Red Safety Lockout Padlocks (KD)	4	LOK007-L
25mm Vinyl Coated Hasp	1	LOK044
Pack (10) Of 'Do Not Operate' Tags	1	LOK050

CONTENTS

Description	Code
Filled LOK219 Station	LOK231
Board Only	LOK219



### Advanced Lockout Station (Large)

Multiple board clips to house padlocks and hasps including additional space for tags and Cable Ties. Supplied with cover that enables the station to be locked out. Engineered from Plastic PC.

Board dimensions (HxWxD): 558 x 393 x 65mm

Description	Quantity	Code
Advanced Station Lock Board (Large)	1	LOK220
Red Safety Lockout Padlocks (KD)	10	LOK007-L
25mm Vinyl Coated Hasp	1	LOK044
38mm Vinyl Coated Hasp	1	LOK045
Pack (10) Of 'Do Not Operate' Tags	1	LOK050
Pack (10) Of 'Do Not Use' Tags	1	LOK073

CONTENTS

Description	Code
Filled LOK220 Station	LOK232
Board Only	LOK220



# Lockout Tagout - Stations

## 30 Padlock Station (Lockout Board 1)

Description	Quantity	Code
Safety Lockout Padlocks (Red)	30	LOK007-L

Description	Code
Lockout Board 1 With Cover	LOK270
Lockout Board 1 Without Cover	LOK271



## 10 Station (Large - Lockout Board 2)

Description	Quantity	Code
Safety Lockout Padlocks (Red)	10	LOK007-L
Vinyl Coated Lockout Hasp (25mm)	2	LOK044
Vinyl Coated Lockout Hasp (38mm)	2	LOK045
Safety Tag Pen - Ultra Fine (Black)	1	TGPEN01
Lockout Tags (Do Not Operate)	1	LOK050
Lockout Tags (Caution This Equipment Has Been Lockout Out)	1	LOK080

CONTENTS

Description	Code
Lockout Board 2 With Cover	LOK272
Lockout Board 2 Without Cover	LOK273



## Electrical Station (Lockout Board 3)

Description	Quantity	Code
Dielectric Red Safety Lockout Padlock	6	LOK068
Non-Conductive Lockout Hasp (6 Holes)	2	LOK046
Non-Conductive Lockout Hasp (3 Holes)	2	LOK053
Lockout Tags (Do Not Operate)	1	LOK050
Lockout Tags (Caution This Equipment Has Been Lockout Out)	1	LOK080
Lockout Shell Case/Pouch	1	LOK189
Universal Circuit Breaker Lockout	2	LOK043
Aluminium MCB Lockout Toggle	2	LOK161
Miniature Circuit Breaker Lockout (Pin Out Standard)	1	LOK205
Miniature Circuit Breaker Lockout (Pin In Standard)	1	LOK206
Miniature Circuit Breaker Lockout (Tie Bar)	1	LOK207
Miniature Circuit Breaker Lockout (Pin Out Wide)	1	LOK208
Universal Extra Large Circuit Breaker Lockout	1	LOK142
Universal Fuse Circuit Breaker Lockout	1	LOK140
Safety Tag Pen - Ultra Fine (Black)	1	TGPEN01

CONTENTS

Description	Code
Lockout Board 3 With Cover	LOK274
Lockout Board 3 Without Cover	LOK275





## Combination Lockout Stations: Build Your Own

Personalised Lockout Stations are easily created with our new combination boards.

Each board has integral locator holes which allow the fitting of a variety of board components, giving the freedom to design the Station the way you want it. Simply tell us what components are required and we will build the board to your specifications. (Stations can be supplied with or without contents).

### Examples of available combinations:



### Lockout Station Board

- Lockout Station backing board.

Size (HxWxD): 601 x 590 x 96mm

Code: LOK223



### Station Cover

- Covers the whole board, lockable at the bottom.

Size (HxWxD): 600 x 570 x 70mm

Code: LOK224



### Extra Wide Pocket

- Full width board pocket.
- House Cable Lockouts, padlocks or non hanging Lockout devices.

Inner Size (HxWxD): 135 x 556 x 135mm

Code: LOK222



### Small Pocket

- Ideal for holding Lockout tags.

Inner Size (HxWxD): 85 x 77 x 30mm

Code: LOK225



### Enclosed Pocket

- Ideal for holding keys, phones etc.
- Integral padlock fixing hole.

Inner Size (HxWxD): 105 x 165 x 27mm

Code: LOK221



### A4 Plastic Clipboard

- Hard Plastic clipboard.
- Ideal for displaying work permits and other documentation.

Size (HxW): 330 x 227mm

Code: LOK227



### Board Clip

- Allow padlocks and hasps to be hung on the board.

Code: LOK226



Remember if you need Padlocks you can find them on [page 155](#), Lockout Tags on [page 182](#) and Permanent Pens on [page 183](#).

# Lockout Tagout - Stations

## Tag Station

As storage stations for tags, these are ideal for large maintenance depots or departments. Made of durable Acrylic, featuring eight plastic tag holders. Supplied with wall fixings.

Size (HxWxD)	Code
Filled 8 Tag Station	LOK233
8 Tag Station (445 x 445 x 45mm (Station only))	LOK153
Filled 10 Tag Station	LOK234
10 Tag Station (540 x 408 x 100mm (Station only))	LOK218

Our filled stations come complete with a selection of our most popular tags, alternatively you may choose 8/10 tags (depending on your board) from those detailed on page 181. Please confirm your selection when ordering.



## Lockout Tagout Station (Window)

Yellow cabinet with 2 adjustable shelves and plastic window.

- Quality powder coated Steel.
- Wall mountable.
- Fixings included.
- 2 keys included.

Size (HxWxD)	Code
410 x 360 x 155mm	LOK151



## Small Tag Station

- Holder for a single pack of tags.
- Complete with fixings.
- Tags not included.

Size (HxWxD)	Code
230 x 130 x 30mm	LOK154



## Lockout Tagout Station

Yellow cabinet with 2 adjustable shelves and carry handle.

- Quality powder coated Steel.
- Wall mountable.
- Fixings included.
- 2 keys included.
- Carry handle.

Size (HxWxD)	Code
410 x 360 x 155mm	LOK060



## 'Tag and Tie' Station

High-quality plastic tag holder with 3 hooks for padlocks and hasps.

- Ideal for storing tags, plastic Cable Ties and markers.
- Complete with fixings.
- Tags not included.

Size (HxWxD)	Code
250 x 145 x 40mm	LOK149



**Find our full range of Lockout Tags on page 182.**



## What are Lockout kits?

Our pre-selected kits are designed to cover most common needs. Each kit is supplied in a carry case and provides a convenient choice for any Lockout professional.

## When are Lockout kits needed?

Ideal for keeping essential Lockout equipment in one convenient place, without the need to return to a Lockout Station.

### Residential Electrical Lockout Kit

Description	Qty	Code
Lockout Shell Case/Pouch	1	LOK189
Red Safety Lockout Padlocks (KD)	2	LOK007-L
Aluminium MCB Lockout Toggle	1	LOK161
Single Tag with Eyelet (Double Sided)	1	LOK241
Ultra-fine Permanent Pen	1	TGPEN01

CONTENTS



Size	Code
6 Piece Kit	LOK228

### Electrical Lockout Kit

Description	Qty	Code
Lockout Shell Case/Pouch	1	LOK189
Red Safety Lockout Padlocks (KD)	2	LOK007-L
Single Tag with Eyelet (Double Sided)	2	LOK241
MCB Lockout (Pin Out Standard)	1	LOK205
MCB Lockout (Pin In Standard)	1	LOK206
MCB Lockout (Pin Out Wide)	1	LOK208
Yellow MCB Lockout (Universal)	1	LOK121
Yellow MCB Lockout (Type 1)	1	LOK122
Ultra-fine Permanent Pen	1	TGPEN01

CONTENTS



Size	Code
11 Piece Kit	LOK229

**Don't forget... when using Lockout equipment you also need Safety Padlocks and Tags.**

Find Padlocks on page 155 and Tags on page 182.

Our pre-selected kits are designed to cover the most common uses in industry.

Each is supplied in handy carry case providing a **convenient choice** for any **Lockout professional**.

Did you know we also offer bespoke Lockout Kits? Contact our sales team for details.



# Lockout Tagout - Kits

## Advanced Electrical Lockout Kit

Description	Qty	Code
Lockout Shell Case/Pouch	1	LOK189
Red Safety Lockout Padlocks (KD)	2	LOK007-L
Non-Conductive Lockout Hasp (6 Holes)	1	LOK046
Pneumatic Lockout	1	LOK063
MCB Lockout (Pin Out Standard)	1	LOK205
MCB Lockout (Pin In Standard)	1	LOK206
MCB Lockout (Pin Out Wide)	1	LOK208
MCB Lockout (Tie Bar)	1	LOK207
Universal Fuse Circuit Breaker Lockout	1	LOK140
Universal Extra Large Circuit Breaker Lockout	1	LOK142
Universal Circuit Breaker Lockout	1	LOK043
Pack (10) of 'Do Not Operate' Tags	1	LOK050
Universal MCB Lockout	1	LOK141
Ultra-Fine Permanent Pen	1	TGPEN01

CONTENTS



Size	Code
15 Piece Kit	LOK251

## Maintenance Lockout Kit

Description	Qty	Code
Lockout Shell Case/Pouch	1	LOK189
Red Safety Lockout Padlocks (KD)	2	LOK007-L
Single Tag with Eyelet (Double Sided)	2	LOK241
MCB Lockout (Pin Out Standard)	1	LOK205
MCB Lockout (Pin In Standard)	1	LOK206
MCB Lockout (Pin Out Wide)	1	LOK208
Universal Circuit Breaker Lockout	1	LOK043
Aluminium MCB Lockout Toggle	1	LOK161
Multi-Purpose Cable Lockout (2.5m Steel Cable)	1	LOK013
Dielectric Lockout Hasp - 6 Holes	1	LOK046
Ultra-Fine Permanent Pen	1	TGPEN01

CONTENTS



Size	Code
13 Piece Kit	LOK230

**Why not build your own kit using components on pages 151 - 179.**

Choose a bag, box or pouch, then select your LOTO equipment. Don't forget pens - find them on page 181.

## Small Lockout Kit

Description	Qty	Code
Premium Lockout Bag	1	LOK248
Red Safety Lockout Padlocks (KD)	2	LOK007-L
Multi-Purpose Cable Lockout (2.5m Steel Cable)	1	LOK013
Vinyl Coated Lockout Hasp (38mm)	1	LOK045
Pack (10) of 'Do Not Operate' Tags	1	LOK050
Ultra-Fine Permanent Pen	1	TGPEN01
Adjustable Gate Valve	1	LOK006
Small Ball Valve Lockout	1	LOK023
Universal MCB Lockout	1	LOK043
Pneumatic Lockout	1	LOK063

CONTENTS

11  
PIECE



Size	Code
11 Piece Kit	LOK250

## Medium Lockout Kit

Description	Qty	Code
Premium Lockout Bag	1	LOK248
Small Ball Valve Lockout	1	LOK023
Multi-purpose Cable Lockout (2.5m Steel Cable)	1	LOK013
Vinyl Coated Lockout Hasp (25mm)	1	LOK044
Vinyl Coated Lockout Hasp (38mm)	1	LOK045
Red Safety Lockout Padlocks (KD)	2	LOK007-L
Pack (10) of 'Do Not Operate' Tags	1	LOK050
Ultra-Fine Permanent Pen	1	TGPEN01
Caution Lockout A-Board	1	4707
Adjustable Gate Valve Lockout	1	LOK006
MCB Lockout (Pin Out Standard)	1	LOK205
Universal MCB Lockout	1	LOK043
Pneumatic Lockout	1	LOK063

CONTENTS

14  
PIECE



Size	Code
15 Piece Kit	LOK116

## Large Lockout Kit

Description	Qty	Code
Premium Lockout Bag	1	LOK248
Small Ball Valve Lockout	1	LOK023
Large Ball Valve Lockout	1	LOK025
Multi-purpose Cable Lockout (2.5m Steel Cable)	2	LOK013
Vinyl Coated Lockout Hasp (25mm)	2	LOK044
Vinyl Coated Lockout Hasp (38mm)	2	LOK045
Red Safety Lockout Padlocks (KD)	6	LOK007-L
Pack (10) of 'Do Not Operate' Tags	3	LOK050
Ultra-fine Permanent Pen	2	TGPEN01
Gate Valve Lockout (25-63.5mm)	1	LOK001
Gate Valve Lockout (63.5-127mm)	1	LOK002
Gate Valve Lockout (127-165mm)	1	LOK003
Caution Lockout in Operation A-Board	1	4707
Large plug/Pneumatic Lockout	1	LOK030
MCB Lockout (Pin Out Standard)	1	LOK205
MCB Lockout (Pin In Standard)	1	LOK206
MCB Lockout (Pin Out Wide)	1	LOK208
Universal MCB Lockout	2	LOK043
Pneumatic Lockout	1	LOK063
3-Phase Dial Lockout	1	LOK055

CONTENTS

32  
PIECE  
OUR  
LARGEST  
KIT



Size	Code
32 Piece Kit	LOK117

# Lockout Tagout - Accessories

## Plug and Hoist Control Cover

Manufactured using hard wearing Polyester cloth with reinforced inserts and a PVC liner. Used to enclose plugs and hanging control panels.



Colour	Code
Red	LOK216

## Premium Lockout Pouch

Hard shell Nylon pouch with integral pocket webbing.

Dimensions (HxWxD):  
75 x 265 x 165mm



Colour	Code
Red	LOK189

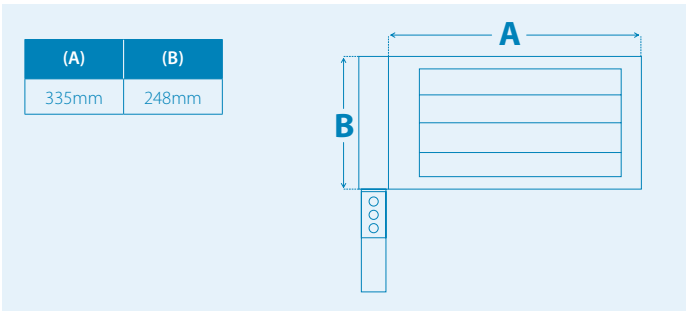

## Belt Pouch

Three pocket belt pouch made from woven Nylon with 3 pockets and adjustable waist strap suitable for up to a 40" waist.



Colour	Code
Red	LOK072

## Premium Lockout Bag

High quality Nylon Lockout bag with reinforced solid waterproof base. Complete with detachable shoulder strap and 3 pockets.

Dimensions (HxWxD):  
300 x 460 x 280mm



Code
LOK248

## Lockout Satchel

Large satchel type Lockout bag, waterproof and suitable for carrying larger Lockout equipment over the shoulder.



Colour	Code
Red	LOK057

## Lockout Toolbox

Sturdy Plastic toolbox with Steel catches, in-lid storage and tote tray.

Dimensions (HxWxD):  
265 x 295 x 555mm



Code
LOK249

## Need a Site Survey?

By law the correct safety signage should be displayed in the appropriate locations and to current legal standards. A Site Survey is advisable if you are unsure of your legal obligations or have been notified by a regulatory body that your current signage is not adequate.

- Site Surveys identify the signs you need, including size, positioning and materials, as well as any bespoke sign manufacturing service needs.
- Site Surveys also provide advice on ensuring the safety of you and your staff, including Lockout Tagout and Asset Management.

To find out how Site Surveys can help your business please contact our sales team.



**Why not build your own kit using components on pages 151 - 179.**

Choose a bag, box or pouch, then select your LOTO equipment. Don't forget pens - find them on page 181.



## Lockout Signs

Our Lockout signs are designed to be highly visible for use as a temporary or permanent reminder to adhere to Lockout procedures. Manufactured on rigid PVC, they can be fixed in place using adhesive or pierced and hung at the point of Lockout.

Rigid 1mm PVC board (non adhesive).



## Magnetic Lockout Signs

Printed on quality white faced magnetic substrate, these signs are easy to attach and provide clear and important messages at the point of isolation.

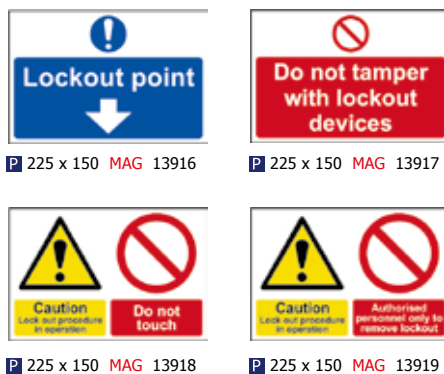

**Custom design and manufacturing available on request.**

## Heavy Duty A-Boards

These heavy duty Polypropylene A-Boards are printed on both sides. Ideal for placement around the workplace and near equipment being locked out.

Size: 620 x 300 x 450mm.

**Find our full range of A-Boards on page 108.**

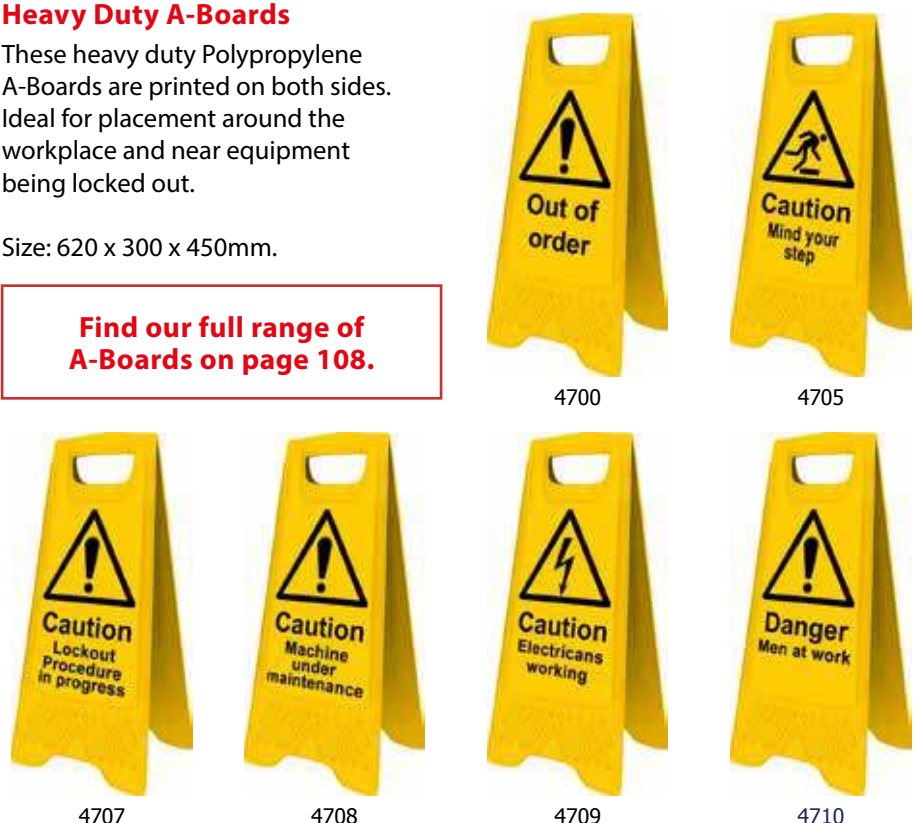

# Lockout Tagout - Miscellaneous and Tags

## Steering Wheel Covers

These highly visible covers can be used to encapsulate a steering wheel preventing unauthorised use. It can be locked out with a suitable padlock.

Size	Code
400mm dia	LOK157
500mm dia	LOK158
600mm dia	LOK159



## Temporary Barriers

An easy way to cordon off equipment being locked off, these Plastic chains and posts are easily moved (the post bases can be filled with water or sand for extra weight).

900mm Chain Posts with Base	
Description	Code
Red/White Post	S0300RW
Yellow/Black Post	S0300YB
5m Plastic Chain and Accessories	
Description	Code
White Chain	S0303WH
Red/White Chain	S0303RW
Yellow/Black Chain	S0303YB
Black Chain Connector	S0302B
White Chain Connector	S0302W



Chain connectors are supplied in packs of 10.

## Snap Frames

Used to house signs and posters. Manufactured from Aluminium, in a range of sizes. Each has a 25mm extruded and self coloured frame and comes complete with fixings and an anti-glare cover.

Size	Code
A4 (210 x 297mm)	13000
A3 (297 x 420mm)	13001
A2 (420 x 594mm)	13002
A1 (594 x 841mm)	13003
20" x 30" (508 x 762mm)	14774
30" x 40" (762 x 1016mm)	14775



View our full range of Snap Frames on page 126.

## Permanent Fine Liner Pen

Quantity	Code
Each	TGPEN01
Pack of 10	TGPEN02



These permanent ultra-fine marker pens can write on almost any surface. The waterproof and smudge proof ink dries in seconds with almost no odour, and is ideal for use with our tags and padlocks.

## Lockout Tags With Eyelet

Highly visible warning tags which should be applied alongside a Lockout device to provide details of the Lockout procedure. Designed to be placed directly on the lock shackle through the tag. Manufactured from durable non-tear Polypropylene which is resistant to water, oils and extreme temperatures.

Tags are printed using UV resistant inks, double-sided and supplied packs of 10.

Complete with eyelet for use without a tie wrap.

Size: 75 x135mm.

FRONT

LOK235

LOK236

LOK237

LOK238

LOK278

LOK279

LOK280

LOK240

REVERSE

LOK235

LOK236

LOK237

LOK238

LOK278

LOK279

LOK280

LOK240

Packs of 10

## Single Sided Lockout Tags

These highly visible warning tags should be applied alongside a Lockout device to provide details of the Lockout procedure. Manufactured from durable non-tear Polypropylene which is resistant to water, oils and extreme temperatures.

Printed using UV resistant inks, single-sided and supplied in packs of 10 complete with Cable Ties.

Packs of 10

Size: 75 x 135mm.



## Double Sided Lockout Tags

Tags are printed on both sides. Supplied in packs of 10 complete with Cable Ties.

Packs of 10

Size: 75 x 135mm.

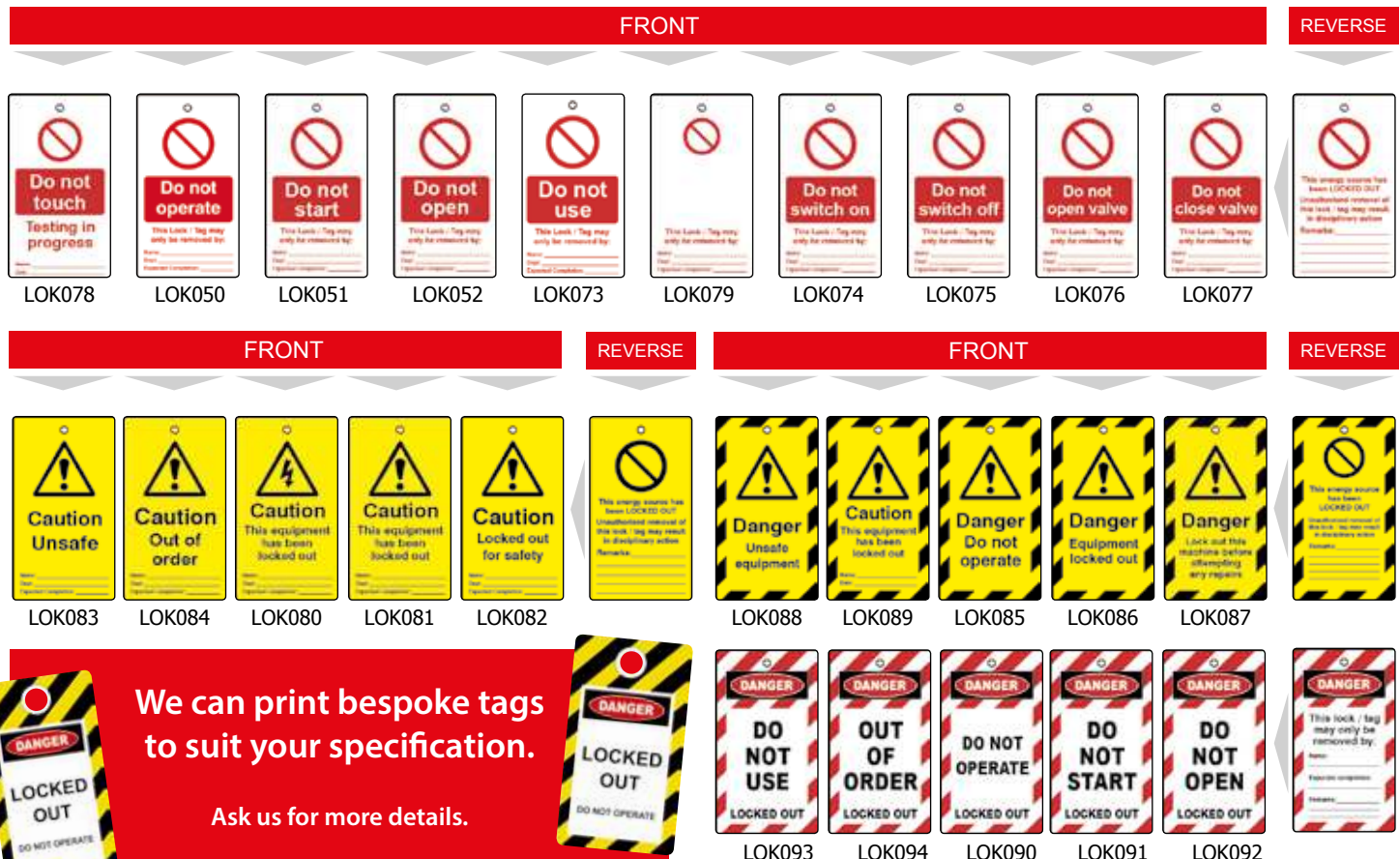

We can print bespoke tags to suit your specification.

Ask us for more details.





**View Lockboxes on page 172**

## Tagging Systems

Scaffold Safety	186
Tower Scaffold Tagging System	186
Scaffold / Tower Tagging System	187
Scaffold Prohibition	187
Racking Safety	188
MEWP Safety	188
Forklift Safety	189
Chemical Safety	189
AssetTag Holders	190
Isolation Tags	190
Flange Tags	190
Ladder Safety	191
LOLER Safety	191
Universal Equipment Inspection	192
MINI Inserts and Holders	193
AssetTag Medium	195
AssetTag Flex	195
Fine Permanent Marker	196
Cable Ties and Custom Cable Ties	196
Permit Document Holder	196

# Tagging Systems

## Scaffold Safety

Use Scaffolding Safety inserts with our ClawTag holder at all legal entry points to the scaffold providing relevant safety information alongside an inspection record. Should the scaffolding fail inspection the insert can be removed to display the message 'Do Not Use This Equipment' or replace with a prohibition insert (shown on **page 185**).

## Scaffold Tagging System

Scaffold must be inspected in the following conditions:

- Following initial erection.
- Exposure to adverse weather.
- Conditions that could affect its strength or stability.
- Following substantial alteration (addition or subtraction).
- At regular intervals not exceeding 7 days from previous inspection.

**SCAFFOLD SAFETY TAG**

REF No. \_\_\_\_\_

Location \_\_\_\_\_

Date erected \_\_\_\_\_

TO BE COMPLETED BY SUPERVISOR

DATE ERECTED \_\_\_\_\_

INSPECTED BY \_\_\_\_\_

DATE INSPECTED \_\_\_\_\_

IF LAST INSPECTION DATE EXCEEDS 7 DAYS, INSPECT SUPERVISOR IMMEDIATELY BY A COMPETENT PERSON

DATE \_\_\_\_\_

COMMISSIONED DATE \_\_\_\_\_

Have any queries regarding this scaffold please contact \_\_\_\_\_

TELEPHONE \_\_\_\_\_

Warning

FURTHER INFORMATION ON REVERSE

TG01-1

Tag size: 75 x 180mm  
Material: Polypropylene



TG01KIT

TG01-1

TG01BOX

Description	Code
Single Insert (Scaffold)	TG01-1
Pack of 10 Inserts	TG0110
Pack of 50 Inserts	TG0150
Kit (1 Holder, 2 Inserts, 1 Pen)	TG01KIT
Box (10 Holder, 20 Inserts, 2 Pens)	TG01BOX

USE WITH



## Tower Scaffold Tagging System

The Work at Height Regulations 2005 require an assessment to be undertaken before starting any work. Erection should be made to Prefabricated Access Suppliers and Manufacturers Association (PASMA) approved methods.

The Tower Scaffold Safety Tag provides an essential platform for entering and storing essential safety information, including movements and safe weight tolerances. Designed for use with the ClawTag holder, these tags can be fixed to the scaffold after erection without needing to dismantle part of the structure.

**TOWER SCAFFOLD SAFETY TAG**

**VERY LIGHT DUTY**

MAXIMUM WEIGHT PER PLATFORM \_\_\_\_\_

MAXIMUM TOTAL SCAFFOLD WEIGHT \_\_\_\_\_

Tower specifications, weight limits, analysis and dismantling procedures should be detailed in the instruction manual supplied with the tower.

INSTRUCTION MANUAL SUPPLIED (Y/N) \_\_\_\_\_

TOWER REF No. \_\_\_\_\_

DATE ERECTED \_\_\_\_\_

ERECTED BY \_\_\_\_\_

INSPECTED BY \_\_\_\_\_

LOCATION 1 \_\_\_\_\_

DATE \_\_\_\_\_

LOCATION \_\_\_\_\_

SIGNATURE \_\_\_\_\_

Do not use this equipment

INFORMATION TAG IS MISSING

FURTHER INFORMATION ON REVERSE

TG12-1

Essential safety and audit information can be referenced with the storage of these inserts after job completion.

Tag size: 75 x 180mm  
Material: Polypropylene



TG12KIT

TG12-1

TG12BOX

Description	Code
Single Insert (Tower)	TG12-1
Pack of 10 Inserts	TG1210
Pack of 50 Inserts	TG1250
Kit (1 Holder, 2 Inserts, 1 Pen)	TG12KIT
Box (10 Holder, 20 Inserts, 2 Pens)	TG12BOX

USE WITH





## Scaffold / Tower Tagging System

This kit offers both the Scaffold Safety Tag insert and the Tower Scaffold Safety Tag insert alongside a holder to provide an essential part of your safety procedure on site.

Designed for use with the ClawTag holder, these tags can be fixed after erection without needing to dismantle the structure.

For more information on individual inserts please refer to Scaffolding / Tower Scaffolding Tagging System.

Tag size: 75 x 180mm  
Material: Polypropylene



## Scaffold Prohibition

**Side 1:** To be displayed if scaffold has failed inspection, warning not to use until it has been made safe and passed re-inspection.

**Side 2:** Used to temporarily prohibit access to certain sections of a scaffold.

Inserts are designed for use with the ClawTag holder, see page 188 for further details.

Tag size: 75 x 180mm  
Material: Polypropylene



Find the full range of AssetTag Holders on page 190.

Description	Code	USE WITH
Kit (1 Holder, 1 x TG01-1 and 1 x TG12-1, 1 Pen)	TG13KIT	

Description	Code	USE WITH
Single Insert (Scaffold Prohibition)	TG08-1	
Pack of 10 Inserts	TG0810	
Pack of 50 Inserts	TG0850	
Box (10 Holders, 20 Inserts, 2 Pens)	TG08BOX	



## Looking for something bespoke?

Contact us today to find out more.



# Tagging Systems

## Racking Safety

Due to the weight, size and loads involved with modern racking it must be checked regularly to ensure the safety of staff and visitors. Our racking tag holders are a modified version of the AssetTag Max system and are designed to be fixed to the crossbeams of the racking displaying racking specific safety messages.

A checklist on the insert describes the checks which must be made and includes space for inspection details to be recorded.

An area is available for completion should intermediate work be required, whereas the insert should be removed totally if the racking is deemed unsafe. This will then display the 'Do Not Use Unsafe Racking' message pre printed on the holder.

Inserts are designed for use with the AssetTag RACKING holder, see **page 188** for further details.

Tag size: 75 x 180mm  
Material: Polypropylene

Find the full range of AssetTag Holders on page 190.



TGRK5



TG09-1  
OUTSIDE



TG09-1  
INSIDE



TG09BOX

Description	Code
Single Insert (Racking Safety)	TG09-1
Pack of 10 Inserts	TG0910
Pack of 50 Inserts	TG0950
Box (10 Holders, 20 Inserts, 2 Pens)	TG09BOX

### USE WITH



## MEWP Safety

The Work at Height Regulations came into force in 2005. These regulations apply to work at height where there is a risk of fall liable to cause personal injury. It states that 'equipment for work at height is properly inspected and maintained'. MEWPs (Mobile Elevating Work Platforms), scissor lifts, booms and cherry pickers are included under this instruction.

A daily pre-work inspection should be carried out and recorded on these tags.

The AssetTag MAX holder should be permanently fixed to the equipment in a suitable safe place. Perform an inspection (a checklist is printed on the reverse) and record the result on the tag. In the event of the equipment failing the inspection, remove insert and inform a supervisor.

Inserts are designed for use with the AssetTag MAX holder, see **page 188** for further details. The AssetTag MAX holder clearly states 'Do Not Use This Equipment' when the tag is removed.

Tag size: 75 x 180mm  
Material: Polypropylene



TG11BOX



TGMX5



TG11-1

Description	Code
Single Insert (MEWP Safety)	TG11-1
Pack of 10 Inserts	TG1110
Pack of 50 Inserts	TG1150
Box (10 Holders, 20 Inserts, 2 Pens)	TG11BOX

### USE WITH



## Forklift Safety

An employer must ensure that a forklift is safe to use and all forklifts should be checked by a competent person prior to use for any damage, faults or wear.

On the reverse the Forklift Safety Tag lists the basic safety checks needed with an inspection record (date, signature, defects reported) on the front.

Designed for use with the AssetTag MAX holder which should be fixed permanently at the point of access to the forklift. If the forklift is safe to use the insert can be slid into the holder with the signature side showing.

The AssetTag MAX holder clearly states 'Do Not Use This Equipment' when the tag is removed, should an inspection find any failures.

Tag size: 75 x 180mm  
Material: Polypropylene



Description	Code
Single Insert (FLT)	TG02-1
Pack of 10 Inserts	TG0210
Pack of 50 Inserts	TG0250
Box (10 Holders, 10 Inserts, 1 Pen)	TG02BOX

### USE WITH



## Chemical Safety

Our Chemical insert has been specifically designed to display important and relevant information in one place.

Details include:

- Chemical name(s).
- Emergency telephone numbers.
- Supplier details and references.
- Immediate action and first aid alongside notes for medical personnel.
- Spillage treatment and disposal.
- Appropriate fire extinguishing and PPE information.

Removal of the insert displays the 'Do Not Use' message on the holder. In an accident, the insert can be given to emergency personnel, providing vital information for diagnosis and treatment.

Inserts designed for use with the AssetTag MAX holder, see **page 188** for further details.

Tag size: 75 x 180mm  
Material: Polypropylene



Description	Code
Single Insert (Chemical Safety)	TG03-1
Pack of 10 Inserts	TG0310
Pack of 50 Inserts	TG0350
Box (10 Holders, 10 Inserts, 1 Pen)	TG03BOX

### USE WITH



We can produce custom Inserts to suit your exact specification including adding your company branding or details.

Please contact the sales office for more information.



# Tagging Systems

## AssetTag Holder

Holders can be fixed using the following: cable ties, rivets, adhesive strips or glue, inbuilt claw (Claw Tag only), keyring or split-ring (AssetTag MINI only).

Each holder also has a 'break' in the edge wall to allow for easy removal of the insert. Use a screwdriver to prise behind the tag and flip the insert out. All holders are manufactured from a Nylon composite providing excellent strength and flexibility even in temperature extremes.

### USE WITH



### USE WITH



### USE WITH



### USE WITH



### Description

### Code

ClawTag (Pack of 5)	TGCT5
AssetTag MAX (Pack of 5)	TGMX5
AssetTag RACKING (Pack of 5)	TGRK5
AssetTag (Pack of 5)	TGOT5
AssetTag MINI (Pack of 5)	TGMT5



213 x 80 x 6mm  
TGRK5



36 x 82 x 6mm  
TGMT5



55 x 210 x 6mm  
TGOT5



80 x 213 x 6mm  
TGMX5



80 x 280 x 6mm  
TGCT5



### Identify which insert is designed to fit each holder.



Claw Tag Insert Size:	75 x 180mm
AssetTag Insert Size:	50 x 181mm
AssetTag MAX insert Size:	75 x 180mm
AssetTag MINI insert Size:	31 x 47mm

## Isolation Tags

Prevent inadvertent energising of a system with this 2-part perforated tag. Each part is completed by the person in charge with the top half attached to the isolation point and the bottom attached to the permit to work. When both are re-attached to each other the isolation can be classed as removed.

Tag size: 75 x 180mm  
Material: Polypropylene



TG06-1

Description	Code
Single Insert (Isolation Tag)	TG06-1
Pack of 10 Inserts	TG0610
Pack of 50 Inserts	TG0650
50 Inserts, 1 Pen	TG06K

## Flange Tags

These 3-part perforated tags are designed to help control the inspection and maintenance procedure when a flange breaks.

Assisting the user to clearly identify the various stages from initial break through to the re-energisation of the system.

Tag size: 75 x 180mm  
Material: Polypropylene



TG07-1

Description	Code
Single Insert (Flange Tag)	TG07-1
Pack of 10 Inserts	TG0710
Pack of 50 Inserts	TG0750
50 Inserts, 1 Pen	TG07K

## Ladder Tagging System

The Work at Height Regulations came into force in 2005. These regulations apply to work at height where there is a risk of fall liable to cause personal injury. This applies to both internal and external work at height, and includes below ground level and low height.

All ladders should be checked daily and prior to use for any damage, faults or wear and tear. In addition they should be inspected at defined intervals as part of a risk assessment programme. Use these inserts to manage the identification, safety, maintenance of ladders and help conform to the Work at Height Regulations 2005.

The AssetTag holder should be permanently fixed to the ladder in a suitable safe place. Perform an inspection of the ladder (a checklist is printed on the reverse) and record the result on the tag. If the ladder fails the inspection remove insert and inform a supervisor. Consider using a Ladder Lockout, see [page 28](#) for more details.

Tag size: 50 x 181mm  
Material: Polypropylene



TG04-1

## LOLER Safety

The Lifting Operations and Lifting Equipment Regulations 1998 (LOLER) covers any equipment used at work for lifting or lowering loads, including anchoring or supporting attachment.

Regulations stipulate that equipment is marked with the appropriate information for its safe use, such as safe working loads.

Daily and weekly checks should be made, in addition to a thorough recorded examination every 6 to 12 months. If the equipment is installed, the location must also be examined at the following points:

- After installation but before first use.
- After assembly but before first use on a site or in a new location.

Should the equipment be hired it should be accompanied by a physical copy of the last examination report. The AssetTag holder should be permanently fixed to the equipment in a suitable safe place.

Perform a thorough inspection of the equipment and complete the insert. In the result of an inspection failure remove insert and inform a supervisor.

Tag size: 50 x 181mm  
Material: Polypropylene



TG04KIT



TGCT5



TG04BOX



TG10BOX



TGCT5



TG10-1

Description	Code
Single Insert (Ladder Safety)	TG04-1
Pack of 10 Inserts	TG0410
Pack of 50 Inserts	TG0450
Kit (1 Holder, 2 Inserts, 1 Pen)	TG04KIT
BOX (10 Holders, 10 Inserts, 1 Pen)	TG04BOX



Description	Code
Single Insert (LOLER Safety)	TG10-1
Pack of 10 Inserts	TG1010
Pack of 50 Inserts	TG1050
BOX (10 Holders, 20 Inserts, 1 Pen)	TG10BOX



# Tagging Systems

## Universal Equipment Inspection

Our Universal Equipment Inspection record helps an employer comply with legislative requirements when inspecting and helps maintain equipment at suitable periods as deemed appropriate by a risk assessment.

The insert has clearly defined areas to record equipment identification or reference numbers, alongside an inspection record. This allows a user instant access to important safety information.

Should equipment fail inspection, the tag can be removed to clearly display the message 'Do Not Use This Equipment' which is printed on the holder.

Inserts are designed for use with the AssetTag holder, see page 188 for further details.

Tag size: 50 x 181mm  
Material: Polypropylene



Description	Code
Single Insert (Universal Inspection)	TG05-1
Pack of 10 Inserts	TG0510
Pack of 50 Inserts	TG0550
BOX (10 Holder, 20 Inserts, 1 Pen)	TG05BOX

USE WITH



**Don't forget to order Ultra Fine Permanent Markers!**

You can find these on **page 196**.



We can produce **Custom Inserts** to suit your exact specification including adding your company branding or details.

**Please contact your sales representative for more information.**





## MINI Inserts

Our smallest inserts are designed for use with our AssetTag MINI tag holders to display relevant identification and safety information.

When the insert is removed (due to equipment fault, maintenance or testing) the message on the holder clearly states 'Do Not Use This Equipment'.



**Ref. No.**

**Next Test Date**

### Next Test

A general purpose insert ideal for use on a variety of equipment and machinery which requires regular safety checks. Suitable for electrical equipment, steps and stools.

**Ref. No.**

**S.W.L.**

**Next Insp. Date Due**

### Safe Working Load

Helps comply with legislative requirements by informing employees of an items safe working load (S.W.L.).

**PASSED FOR ELECTRICAL SAFETY**

**BY**

**DATE**

**NEXT DUE**

**REF:**

### PAT Testing

Designed for Portable Appliance Testing (PAT) this clearly displays the date of test, when next due, item reference along with the testers name.

**ID Number:**

**Inspection Date:**

**Next Inspection:**

**Inspected by:**

### Harness Inspection

To be displayed on a harness strap giving identification and inspection details. These are often colour coded giving 'at a glance' safety information from a distance.

**REF. NO.**

**VIB. MAGNITUDE (M/S<sup>2</sup>)**

**MAX. DAILY USE**

**NOISE LEVEL dB(A)**

**TEST DATE**

### Vibration Control

Designed to help manage Hand Arm Vibration Syndrome (H.A.V.S.) and dangerous noise levels, these display relevant safety information.

Description	Code			
	Green	Yellow	Red	Blue
Next Test (Pack of 20 Inserts)	TG60G	TG60Y	TG60R	TG60B
Next Test Kit (20 Holders, 40 Inserts, 1 Pen)	TG60GK	TG60YK	TG60RK	TG60BK
Safe Working Load (Pack of 20 Inserts)	TG61G	TG61Y	TG61R	TG61B
Safe Working Load Kit (20 Holders, 40 Inserts, 1 Pen)	TG61GK	TG61YK	TG61RK	TG61BK
PAT Testing (Pack of 20 Inserts)	TG62G	TG62Y	TG62R	TG62B
PAT Testing Kit (20 Holders, 40 Inserts, 1 Pen)	TG62GK	TG62YK	TG62RK	TG62BK
Vibration Control (Pack of 20 Inserts)	TG63G	TG63Y	TG63R	TG63B
Vibration Control Kit (20 Holders, 40 Inserts, 1 Pen)	TG63GK	TG63YK	TG63RK	TG63BK
Harness Inspection (Pack of 20 Inserts)	TG64G	TG64Y	TG64R	TG64B
Harness Inspection Kit 1 (20 Holders, 40 Inserts, 1 Pen)	TG64GK	TG64YK	TG64RK	TG64BK

Harness Inspection Kit 2 (20 Holders, 40 Inserts - 10 of Each Colour, 1 Pen)

TG64K-MIX



View our full range of Tag Holders on [page 188](#).



**Custom made Inserts available.**  
**Ask for details.**



# Tagging Systems

## AssetTag Flex

Durable Polyurethane tag designed to highlight key features, inspection dates and safety messages.

### Key Points:

- Flexible and durable.
- Weatherproof.
- 8 Colours available.
- Single or double sided print options.
- Custom design available.

Perfect for use on a multitude of applications including the identification of assets, inspection and safety tagging.

Our tags are manufactured from TPU (Polyurethane) ensuring they are highly flexible, incredibly durable, suitable for all weather conditions and resistant to both high and low temperatures as well as most acids, alkalis and solvents.

Asset Tag Flex works as a complete unit without the need for any further equipment. Using two integral slots the tag can be fastened through itself at two positions depending on the application.

The Medium Tag (shown on the right) is attached to any piece of equipment using a cable tie, rivet or similar.

The Asset Tag series is available in 8 different colours with a wide variety of print options – plain, pre-printed (shown below) or fully customised with your wording or logo.



**Note: these designs are available in all colours and both sizes.**

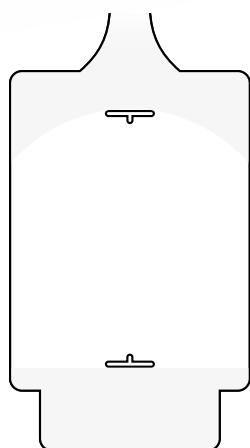

Plain

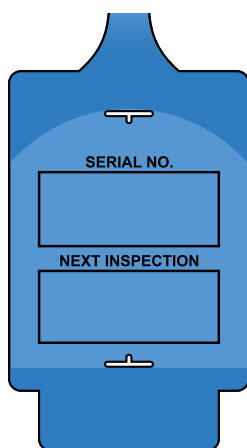

Inspection Style A

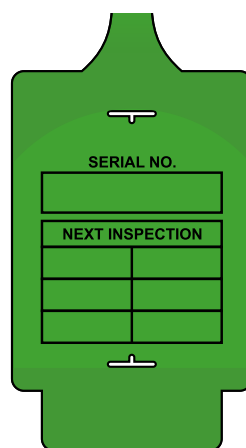

Inspection Style B

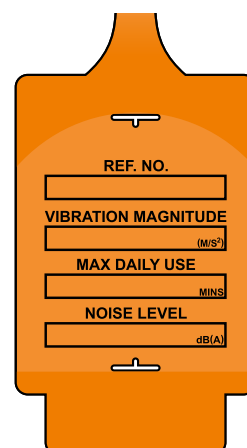

Vibration Control

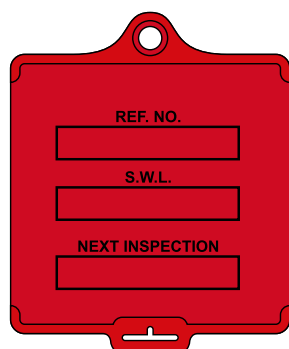

Safe Working Load



Do Not Use Style A



Do Not Use Style B



Custom Design

## AssetTag Medium



Size	
(A)	4.5mm
(B)	60mm
(C)	11mm
(D)	5mm
(E)	2mm
(F)	2mm

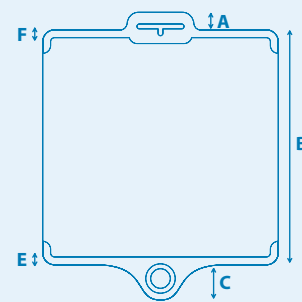

	Blue		Green		Orange		Red		White		Yellow		Lilac		Pink	
Description	1	50 Pk	1	50 Pk	1	50 Pk	1	50 Pk	1	50 Pk	1	50 Pk	1	50 Pk	1	50 Pk
Plain Code Prefix	TGFM-		TGFM-		TGFM-		TGFM-		TGFM-		TGFM-		TGFM-		TGFM-	
Plain Tags	B1	B50	G1	G50	O1	O50	R1	R50	W1	W50	Y1	Y50	L1	L50	P1	P50

Pre-Printed Code Prefix*	TGFM0		TGFM0		TGFM0		TGFM0		TGFM0		TGFM0		TGFM0		TGFM0	
Inspection (Style A)	101B	150B	101G	150G	101O	150O	101R	150R	101W	150W	101Y	150Y	101L	150L	101P	150P
Inspection (Style B)	201B	250B	201G	250G	201O	250O	201R	250R	201W	250W	201Y	250Y	201L	250L	201P	250P
Vibration Control	301B	350B	301G	350G	301O	350O	301R	350R	301W	350W	301Y	350Y	301L	350L	301P	350P
Safe Working Load	401B	450B	401G	450G	401O	450O	401R	450R	401W	450W	401Y	450Y	401L	450L	401P	450P
Do Not Use (Style A)	501B	550B	501G	550G	501O	550O	501R	550R	501W	550W	501Y	550Y	501L	550L	501P	550P
Do Not Use (Style B)	601B	650B	601G	650G	601O	650O	601R	650R	601W	650W	601Y	650Y	601L	650L	601P	650P

Example: TGFM-301W - Single White Medium Tag with 'Vibration Control' Message

\*Standard printed tags are single sided

## AssetTag Flex



Size	
(A)	245mm
(B)	60mm
(C)	15mm
(D)	80mm
(E)	140mm
(F)	10mm
(G)	40mm

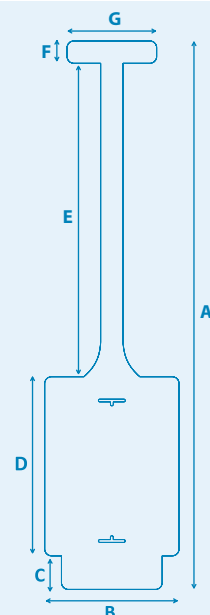

	Blue		Green		Orange		Red		White		Yellow		Lilac		Pink	
Description	1	50 Pk	1	50 Pk	1	50 Pk	1	50 Pk	1	50 Pk	1	50 Pk	1	50 Pk	1	50 Pk
Plain Code Prefix	TGF-		TGF-		TGF-		TGF-		TGF-		TGF-		TGF-		TGF-	
Plain Tags	B1	B50	G1	G50	O1	O50	R1	R50	W1	W50	Y1	Y50	L1	L50	P1	P50

Pre-Printed Code Prefix*	TGF0		TGF0		TGF0		TGF0		TGF0		TGF0		TGF0		TGF0	
Inspection (Style A)	101B	150B	101G	150G	101O	150O	101R	150R	101W	150W	101Y	150Y	101L	150L	101P	150P
Inspection (Style B)	201B	250B	201G	250G	201O	250O	201R	250R	201W	250W	201Y	250Y	201L	250L	201P	250P
Vibration Control	301B	350B	301G	350G	301O	350O	301R	350R	301W	350W	301Y	350Y	301L	350L	301P	350P
Safe Working Load	401B	450B	401G	450G	401O	450O	401R	450R	401W	450W	401Y	450Y	401L	450L	401P	450P
Do Not Use (Style A)	501B	550B	501G	550G	501O	550O	501R	550R	501W	550W	501Y	550Y	501L	550L	501P	550P
Do Not Use (Style B)	601B	650B	601G	650G	601O	650O	601R	650R	601W	650W	601Y	650Y	601L	650L	601P	650P

Example: TGF-450G - Pack of 50 Green Tags with 'Safe Working Load' message

\*Standard printed tags are single sided



# Accessories and Fixings

## Permit Document Holder

Weatherproof with reinforced eyelet for fixing.  
Holds A4 sized documents, with zip opening.

Description	Code
Single	LOK071



## Ultra-fine Permanent Marker

Suitable for writing on all of our asset management products.

Description	Code
Single	TGPEN01
Pack of 10	TGPEN02



## Electrical Labels

Our range of Electrical Safety Labels are durable and convenient. They are supplied in a range of sizes in various size packs and rolls.

Find the full range of Electrical Labels on [pages 138](#).



## Cable Ties

Packs of natural coloured Cable Ties.

Description	Code
102 x 2.5mm Pack (100)	NT20P
160 x 2.5mm Pack (100)	NT21P
200 x 4.8mm Pack (50)	NT50P

